

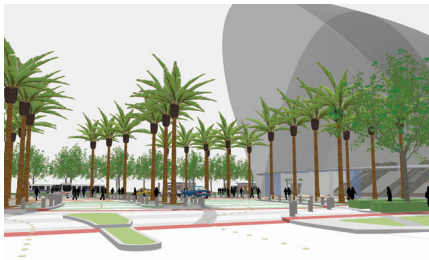

Anaheim Regional Transportation Intermodal Center (ARTIC)



SWA provided urban design and landscape architectural services for the 16-acre Anaheim Regional Transportation Intermodal Center (ARTIC), a significant, LEED Platinum-designed transit facility. ARTIC forms a seamless gateway from Anaheim to all of Orange County, spurring economic growth and community redevelopment throughout the region. The landscape design establishes a unique and identifiable image for the ARTIC Mixed-Use District by complementing the site's iconic architecture with a strong streetscape identity. A large central plaza, designed to evoke the feel of a European square, integrates passenger drop-off areas, a central pedestrian zone, and a forecourt for the terminal building. Artwork is also incorporated into the overall plaza design adding aesthetic diversity. Date

Location
Anaheim, California
Client
City of Anaheim
Orange County Transportation Authority
PB Americas, Inc. (Parsons Brinckerhoff)
SWA Scope
Landscape Architecture
Size
Site: 16.2 acres (6.56 hectares)
Architects
HOK Architects

palms and canopy trees provide a dramatic, shaded outdoor environment for civic events and informal socializing, and visitors are afforded a relaxing riverfront walk along the Santa Ana River.