

BEIJING FINANCE STREET E6

Beijing, China

CLIENT

SOM San Francisco

SCOPE OF WORK

SD through DD

PROJECT SIZE

1.8 hectare

DATE BEGUN

May 2009

DATE OF COMPLETION

N/A

SWA OFFICE

San Francisco

SWA PROJECT TEAM

Jim Lee

Wan-chih Yin

THE BIG IDEA

E6 is an extension of the Beijing Finance Street district development. The program includes governmental archive office, banking halls and offices. The idea is to carry the continuity of BFS yet harmonic and site specific design for the site.

Fuchengmen Nan Shuncheng Jie

Finance Street

Da Jie

E8

E7

A6

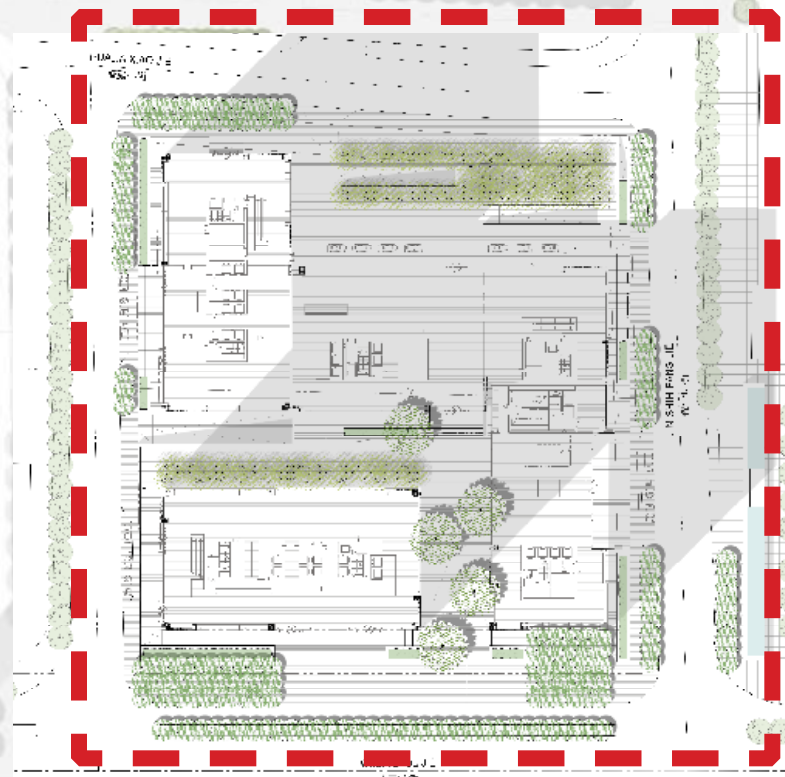

Wudinghou Jie

PROJECT DESCRIPTION

The landscape is an integral part of the architectural concepts and reinforces the project's connectivity with the larger Finance Street district and its system of open spaces. The landscape addresses four principal landscape zones including the streetscape, the north arrival court, the central court, and the new government building and civic plaza. Collectively, the buildings are set on a great stone plinth and stepped to address grade changes along existing streets.

Individual buildings are prominently featured along the public streets. Bosques of trees spatially modulate the streetscape to reveal and highlight the entry portal of individual buildings. Prominently featured opposite the existing civic plaza is the new government office building. Its placement completes the architectural framing/massing of government buildings around the civic plaza. Civic sculpture, fountain wall, broad steps, and new trees to supplement the existing tree bosque link the new tower and existing government buildings to a revitalized civic plaza. Within the project, the buildings form a central court linked to the buildings' open lobby spaces. Leading into the central court, linear tree groves establish a soft vertical massing between the buildings. The court is anchored by five carefully placed specimen trees. Its southern orientation opens to the street where it aligns with the mid-block crossing at F2. At the north arrival court, a delicate tree grove is elegantly presented in concert with the stone plinth and the pavilion building. This court serves both as a northern terminus and portal for Finance Street District.

