

# WUSONG RIVERFRONT COMPETITION

Kunshan, China

SWA OFFICE  
Sausalito

SWA PROJECT TEAM  
Hui-Li Lee, Roy Imamura,  
Bob Jacob, Minhui Li,  
Chih-Wei (GV) Chang,  
Huiqing Kuang, Sarah Peck

PROJECT TYPE  
Master Plan Competition

DATE BEGUN  
Design- NOV 2008



CLIENT  
Kunshan Huaqiao Economical Development and Planning Bureau

CONSULTANTS  
Ojanen\_Chio Architect LLP  
Herrera Environmental Consultants

SCOPE OF WORK  
Regional concept planning for Wusong River green network. Master planning for Oxbow and waterfront. Detail planning and design at the phase one - business service district. Architectural design focuses on Huaqiao Forum, the main building of the project.

SIZE  
Project - 955, 286 sqm  
Building - Phase I: 108,900 sqm  
Phase II: 78,000sqm

THE BIG IDEA  
- Synergy between development and water treatment for amenity and habitat.  
- Maximize the water edge for various scales and layers of experiences.  
- Smaller building mass enable the flexibility of phasing and construction schedule.

PROJECT DESCRIPTION  
Kunshan is a city located right outside of Shanghai, home to many out sourcing companies. This project aims to create a new waterfront district where it provides businesses as well as residents with public amenities and open spaces.  
The design started from the study of Wusong green/water network, identified the resources and opportunities. Then we proposed an integrated development which included water purification system within its infrastructure. The system serves not only for water quality but it's also valuable for outdoor experience, in different scales and layers for different enjoyments.



WUSONG RIVER GREEN NETWORKS

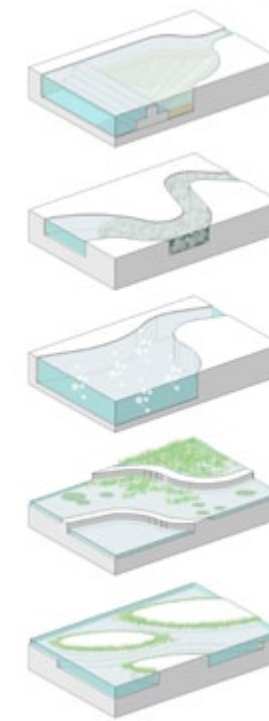

SEDIMENTATION

GRAVEL/ROCK FILTERING

AERATION

AQUA PLANTS CELLS

RIPARIAN EDGE

HUAQIAO FOURM

HOTEL / TRAINING CENTER

CANAL WALK RETAIL

LIBRARY

JIMINGTANG CANAL

RIVER PORT

WUSONG RIVERFRONT BUSINESS SERVICE DISTRICT



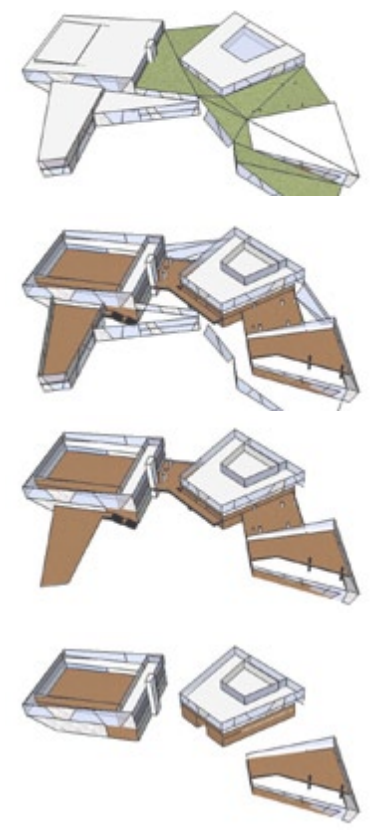

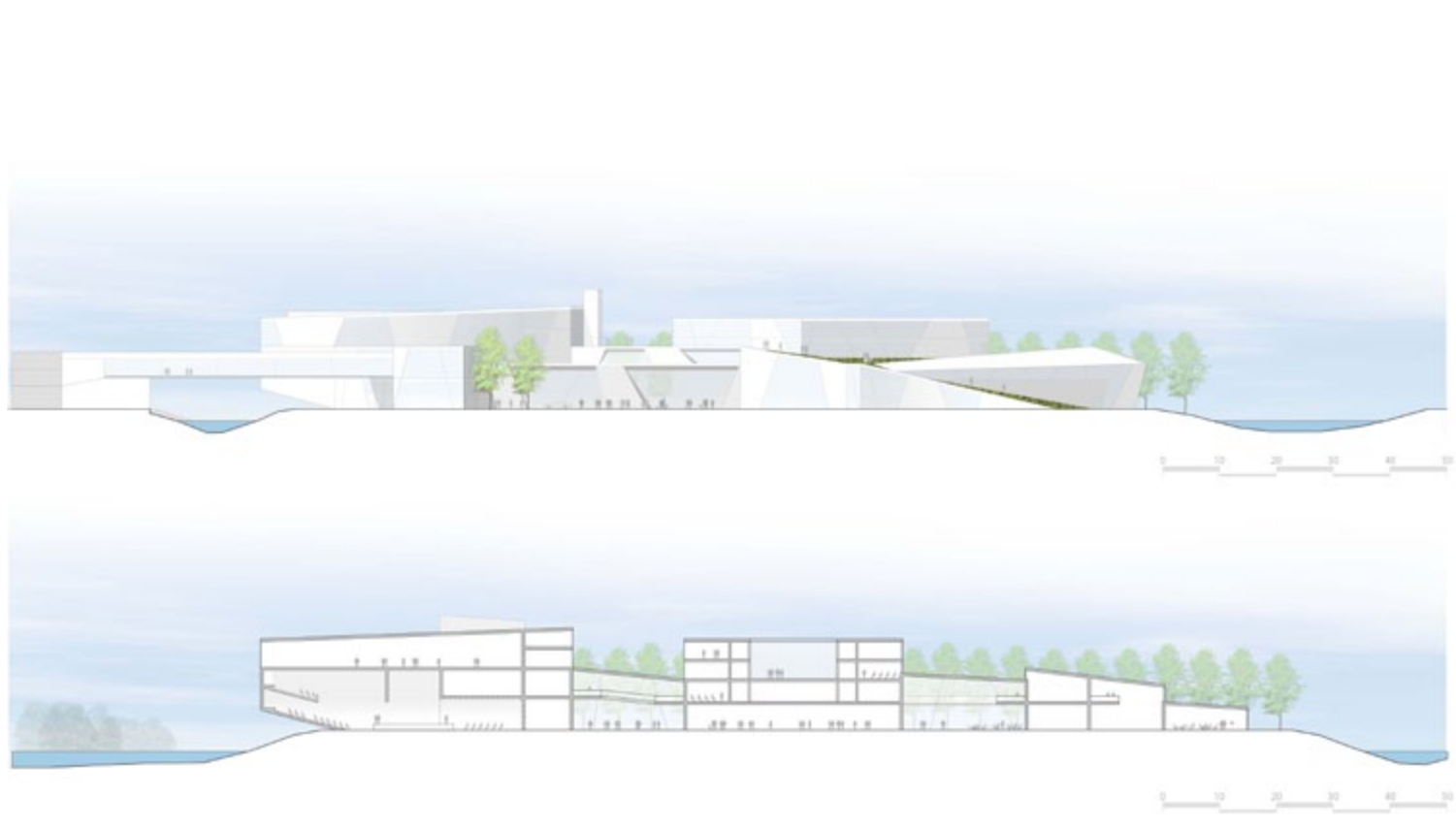

FORUM SECTIONS

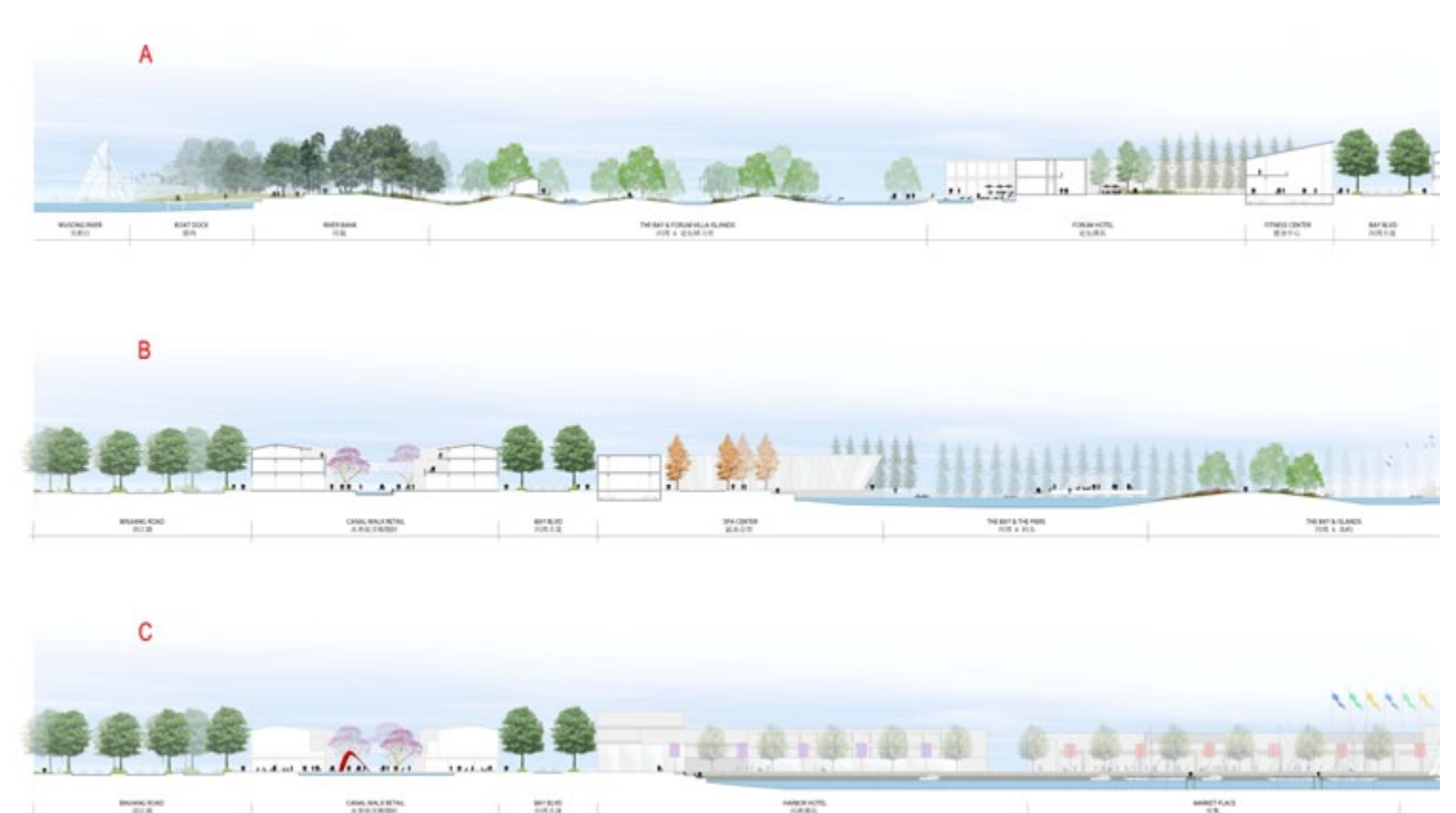

SITE SECTIONS