

2010 landscape urbanism project

# 2010 landscape urbanism project

sarah kathleen peck | swa fellowship 2010

advisors:  
ying-yu hung  
elizabeth shreeve  
gerdo aquino

a website for

landscape architects  
architects  
planners  
urbanists  
designers  
students  
professionals  
clients  
philosophers  
journalists  
people

+

all things urban + landscape

a story  
in 4 parts.

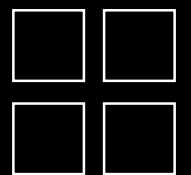

part 1: introductions.

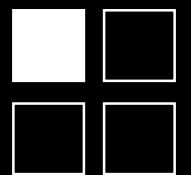

i am  
interested in

the big picture.

i am interested in the way that  
landscape architects and designers  
+ designers  
communicate their ideas.

communicate  
their ideas.

HI!  
MAKE PRESENTATION  
IN 7 MINUTES

# SUPERGRAPHIC V.1.0

INSPIRED BY EDWARD TUFTE  
~~ENACTED~~ BY MAITRI ERWIN  
ATTEMPTED

AUGUST  
2009

- THIS IS NOT AN  
11 X 17 PAGE -  
PROBLEM  
I CARE, YOU CARE  
LET'S FIX IT WITH

HAVE AN  
INTELLECTUAL  
MODEL - KNOW  
WHAT YOU TALK  
ABOUT!

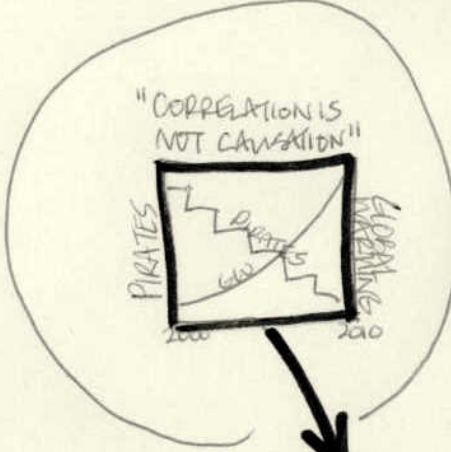

VIZWORLD.COM  
READ MY  
BLOG POST  
LOOK @ PASTOS  
WHATSOEVER  
IT TAKES  
TO GET  
MESSAGE  
ACROSS  
LISTEN W/  
INTERVIEW

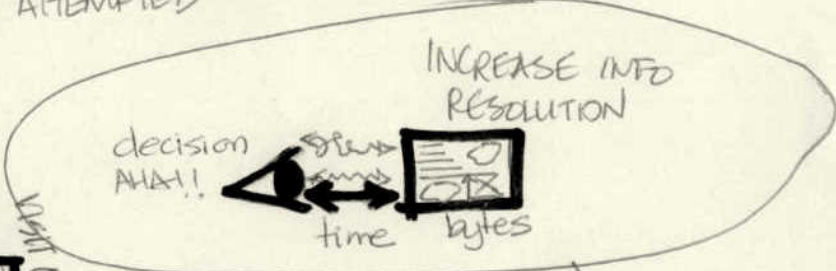

[GET A  
GOOD  
PEN]



SHOW  
CAUSALITY

MULTIVARIATE

MAKE WISE  
COMPARISONS

CREDIBLE

- SHOW UP EARLY  
- FINISH EARLY  
BYE!

REPLACE WORDY  
DESCRIPTIONS  
GOOD DAY? SATURN 66. HAZY DAY?

"NEVER SEGREGATE  
EVIDENCE BY MODE  
OF PRODUCTION"  
MULTIMEDIA IS MEDIA

DO NOT  
FALSIFY  
FILTER + IDENTIFY KEY POINTS  
BUT NO EVIDENCE CORRUPTION

DIRECT  
LABELS  
NO LEGEND!

TO CLARIFY  
ADD DETAIL  
1 - Crime occurred  
2 - at 7:45 PM  
3 - at corner of X+Y str.  
4 - NW corner, ABC store  
5 - 7 suspects at large

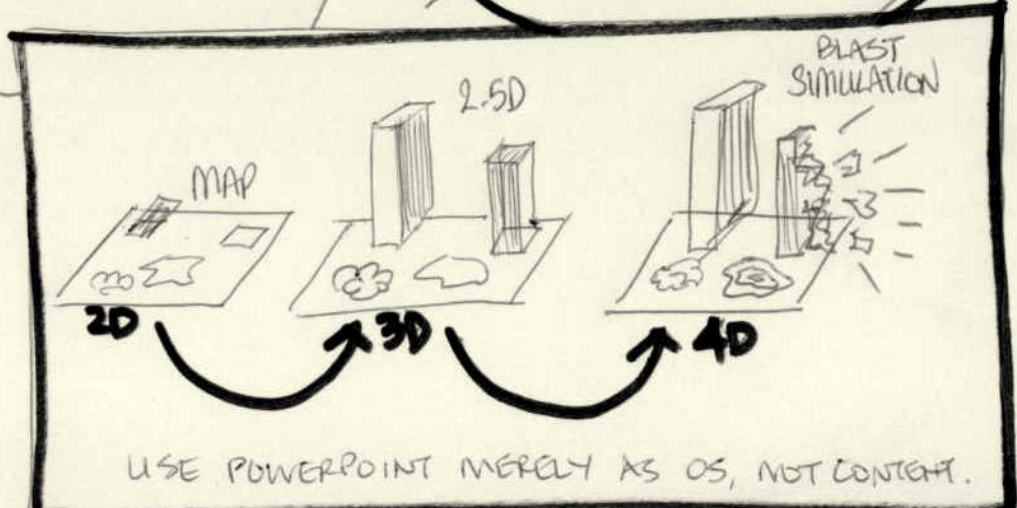

what stories do we tell?  
how do we share our ideas?  
what methods do we use?

Edward R. Tufte

# Envisioning Information



ESCAPING FLATLAND

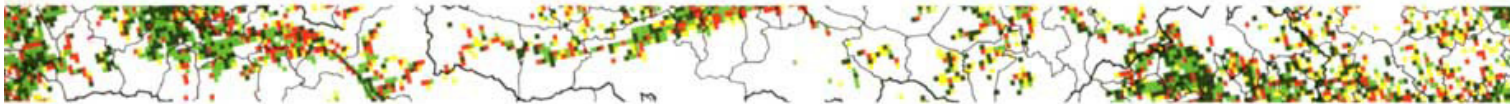

MICRO / MACRO READINGS



LAYERING AND SEPARATION



SMALL MULTIPLES



COLOR AND INFORMATION

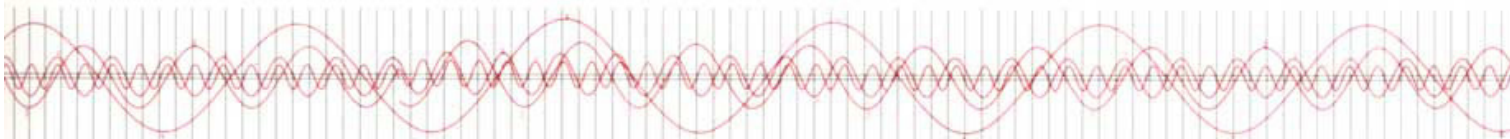

NARRATIVES OF SPACE AND TIME

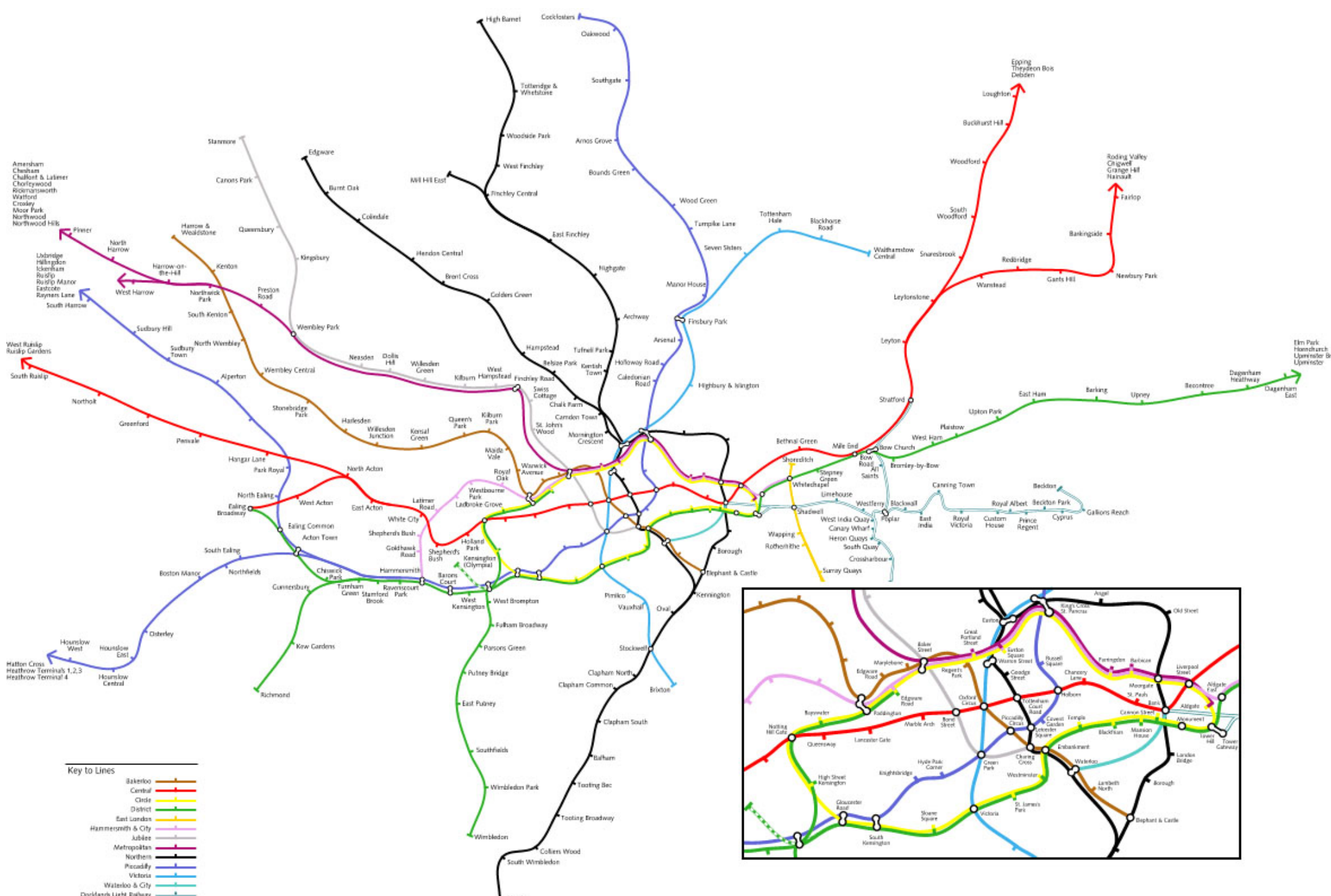

- Key to Lines**
- Bakerloo
  - Central
  - Circle
  - District
  - East London
  - Hammersmith & City
  - Jubilee
  - Metropolitan
  - Northern
  - Piccadilly
  - Victoria
  - Waterloo & City
  - Docklands Light Railway

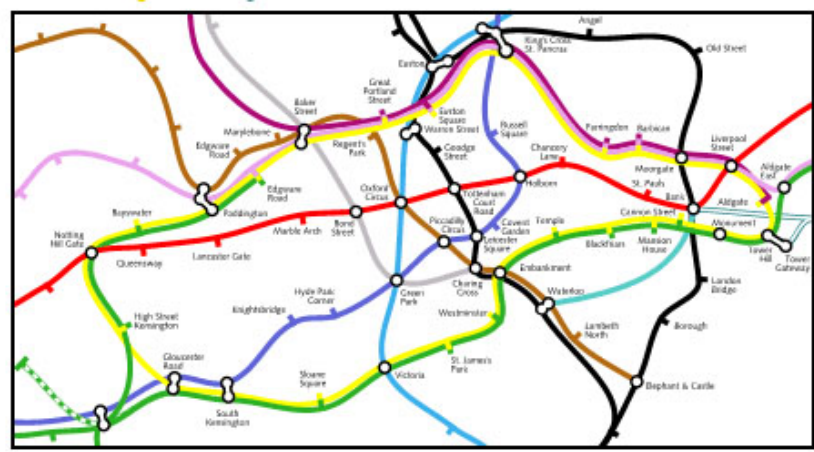



leaflets  
brochures  
books  
posters  
powerpoints  
conceptual design  
master plans  
sd sets  
dd sets  
construction  
documents  
contracts  
presentations  
design guidelines  
image boards

our jobs are as much about  
the creation of documents

as the creation of physical spaces







#### WATER CONCEPT SERIES

**As Longtan Bay Resort, the use of water will enhance the scenic, recreational amenities, quality and promote a sense of movement and excitement. The quality of water and the shape of water in the landscape can help to create the unique atmosphere of "living waterfalls".**

**Sustainability:** The use of water throughout the site reflects the commitment to ecological, social and economic progress, by creating an integrated framework of resources across the entire site to enhance the ecological benefits.

**Accessibility:** The accessibility, safety and quality of public and private spaces will be enhanced through the use of water. The water will be used to create a sense of movement and excitement, and to provide a sense of connection to the natural environment.

**Resilience:** The accessibility, safety and quality of public and private spaces will be enhanced through the use of water. The water will be used to create a sense of movement and excitement, and to provide a sense of connection to the natural environment.



#### ARCHITECTURE CONCEPT SERIES

**The resort Phase One architecture will be provided by a team of architects and designers who will work with the client to create a unique and memorable experience.**

**Sustainability:** The use of water throughout the site reflects the commitment to ecological, social and economic progress, by creating an integrated framework of resources across the entire site to enhance the ecological benefits.

**Accessibility:** The accessibility, safety and quality of public and private spaces will be enhanced through the use of water. The water will be used to create a sense of movement and excitement, and to provide a sense of connection to the natural environment.

**Resilience:** The accessibility, safety and quality of public and private spaces will be enhanced through the use of water. The water will be used to create a sense of movement and excitement, and to provide a sense of connection to the natural environment.



#### WATER CONCEPT SERIES

**As Longtan Bay Resort, the use of water will enhance the scenic, recreational amenities, quality and promote a sense of movement and excitement. The quality of water and the shape of water in the landscape can help to create the unique atmosphere of "living waterfalls".**

**Sustainability:** The use of water throughout the site reflects the commitment to ecological, social and economic progress, by creating an integrated framework of resources across the entire site to enhance the ecological benefits.

**Accessibility:** The accessibility, safety and quality of public and private spaces will be enhanced through the use of water. The water will be used to create a sense of movement and excitement, and to provide a sense of connection to the natural environment.

**Resilience:** The accessibility, safety and quality of public and private spaces will be enhanced through the use of water. The water will be used to create a sense of movement and excitement, and to provide a sense of connection to the natural environment.

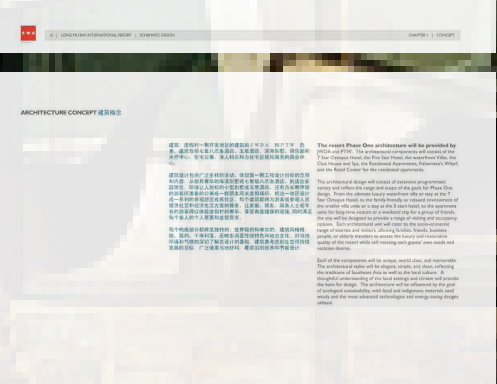

#### ARCHITECTURE CONCEPT SERIES

**The resort Phase One architecture will be provided by a team of architects and designers who will work with the client to create a unique and memorable experience.**

**Sustainability:** The use of water throughout the site reflects the commitment to ecological, social and economic progress, by creating an integrated framework of resources across the entire site to enhance the ecological benefits.

**Accessibility:** The accessibility, safety and quality of public and private spaces will be enhanced through the use of water. The water will be used to create a sense of movement and excitement, and to provide a sense of connection to the natural environment.

**Resilience:** The accessibility, safety and quality of public and private spaces will be enhanced through the use of water. The water will be used to create a sense of movement and excitement, and to provide a sense of connection to the natural environment.

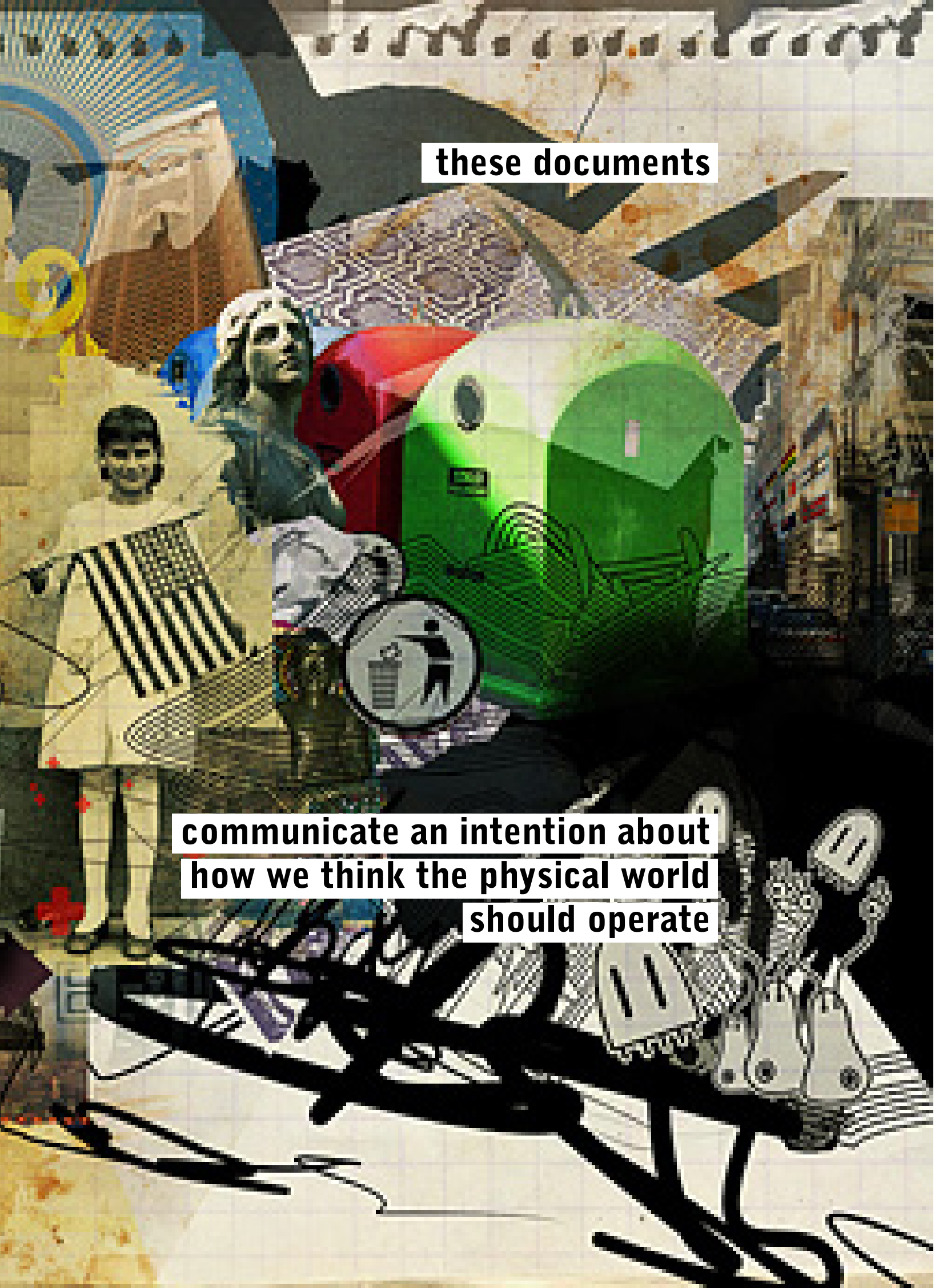

these documents

communicate an intention about how we think the physical world should operate

In the past  
20-30 years, there has  
been an incredible  
transformation  
in the way that  
designers communicate,  
create, and access  
information.

**computers**

**fax machines**

**internet**

**email**

**cell phones**

**blackberries**

**iphones**

**2D Drafting**

**AutoCAD**

**Revit**

**Adobe CS**

**3D Modeling**

**Rhino**

**Sketchup**

**3D CAD**

**BIM - Revit**

**Social Networks**

**Friendster**

**MySpace**

**Blogger**

**Facebook**

**Twitter**

**Google Buzz**

**Culture Clash**

Mult Culturele Apartheid

SUMECO

some questions to consider:



**what works?**

**what tools are effective and which are ineffective?**

some questions to consider:



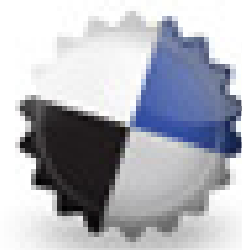

LINKUJ

VYBRALI SME

JAGG

TOP ODKAZY

TOP CLANKY

DELICIOUS

TWITTER

email

cad

rhino

facebook

twitter

youtube



FACEBOOK

FLICKR

REDDIT

RSS

TECHNORATI

STUMBLEUPON

DIGG

revit

tumblr

del.icious.

digg

google



sketchup

basecamp

rss

blog yahoo

wordpress



**what are the tools of this generation that we need to leverage to our advantage - as a company and as a profession?**



(counterpoint:)

**or are there only 2 tools that we really need?**

pencil + paper

(+ imagination)

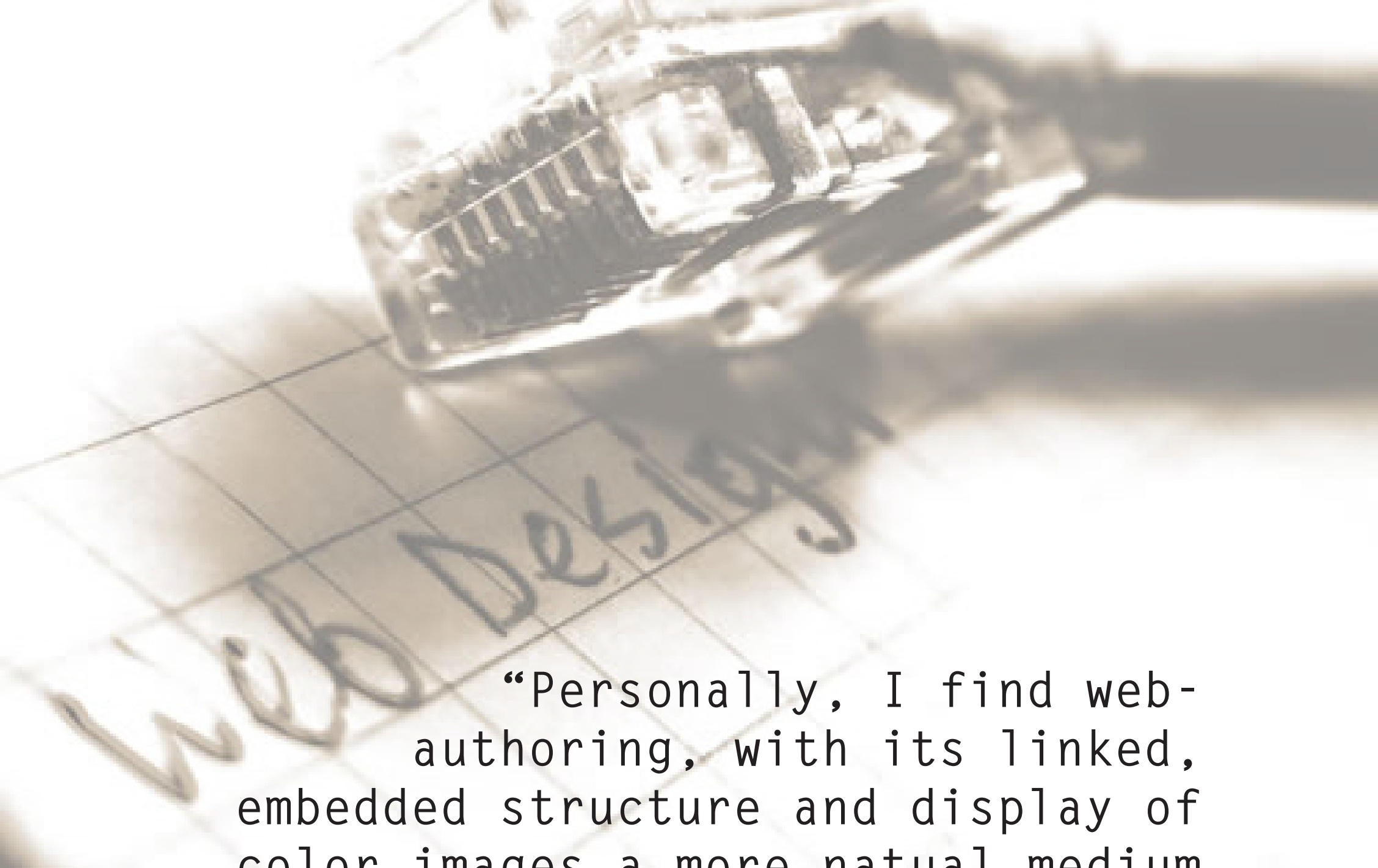

“Personally, I find web-authoring, with its linked, embedded structure and display of color images a more natural medium of expression than any other.

**Anne Whiston Spirn**  
**The Language of Landscape**  
**1998**

my big picture manifesto

# my big picture manifesto

personal thesis:  
(or, my “big picture manifesto”)

my interest is in systems organization + visual information design:

I want to understand the art of visual storytelling.

I am interested in the spatial layout and design of information -  
in virtual as well as physical space.

I am drawn to both the urban design of the world at a human-scale (physical spatial design) and how we communicate our ideas about these spaces - in books, websites, charts, graphs, stories, presentations, and words.

I am also interested in the more intangible qualities of design for understanding: I want to understand the embedded information structures within cities and landscapes, the cues and signs we use for navigation, the art of wayfinding and exploring, and the organization of information in space - both from a design standpoint and from the perceptual understanding of the user.

Websites are continually evolving, dynamic, interactive, and constantly changing documents - that can also become obsolete after the information sets change over time.

**In broad strokes:  
I am interested in the spatial  
layout and design of information  
- in virtual as well as  
physical space.**

# fellowship proposal: framework

personal thesis:  
(or, my “big picture manifesto”)

my interest is in systems organization + visual information design:

I want to understand the art of visual storytelling.

I am interested in the spatial layout and design of information -  
in virtual as well as physical space.

I am drawn to both the urban design of the world at a human-scale (physical spatial design) and how we communicate our ideas about these spaces - in books, websites, charts, graphs, stories, presentations, and words.

I am also interested in the more intangible qualities of design for understanding: I want to understand the embedded information structures within cities and landscapes, the cues and signs we use for navigation, the art of wayfinding and exploring, and the organization of information in space - both from a design standpoint and from the perceptual understanding of the user.

Websites are continually evolving, dynamic, interactive entities - living documents - that can also become obsolete after the information sets change over time.

There are many parallels  
between the design of information space  
and the design of physical space.

# fellowship proposal: framework

can  
we  
build  
an

{  
interactive  
live  
evolving  
}

tool  
for/  
about

{  
emerging  
topic in  
landscape  
}

?

a website for

landscape architects  
architects  
planners  
urbanists  
designers  
students  
professionals  
clients  
thinkers  
journalists  
people

+

all things urban + landscape



part 2: process.

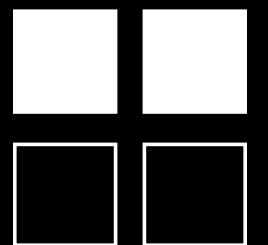

# 2010 landscape urbanism project

week 1

explorations: 4 cities  
taipei, portland, seattle, los angeles

week 2

research + reading  
annotated bibliography

1: Ying-Yu & Gerdo

week 3

website + template design  
iterations of design  
content structure + framework

2: Elizabeth + Josselyn

3: Blink Tag, Inc

week 4

presentation design  
Nancy Duarte: SLIDE\_OLOGY, RESONATE

4: Ying-Yu & Gerdo

▶ presentation

5: SWA Principals Meeting

website coding + launch  
content build-out

contacts: get involved  
funding + financing

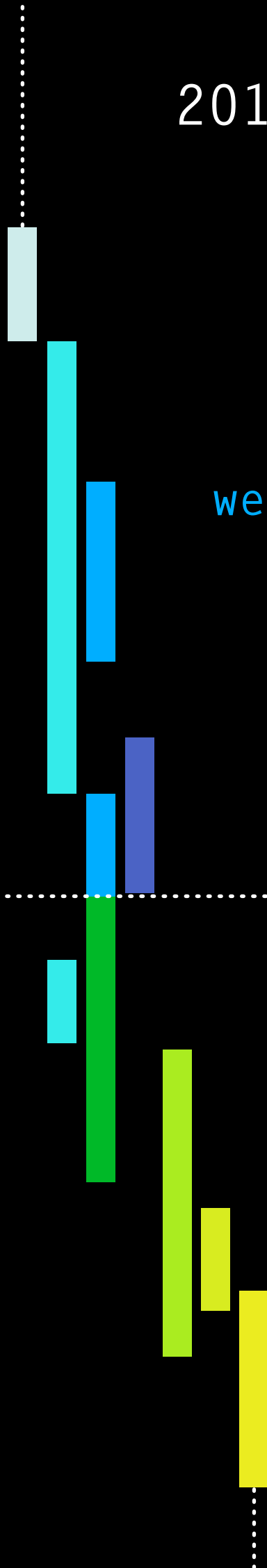

explorations: 4 cities.

taipei



taipei

portland

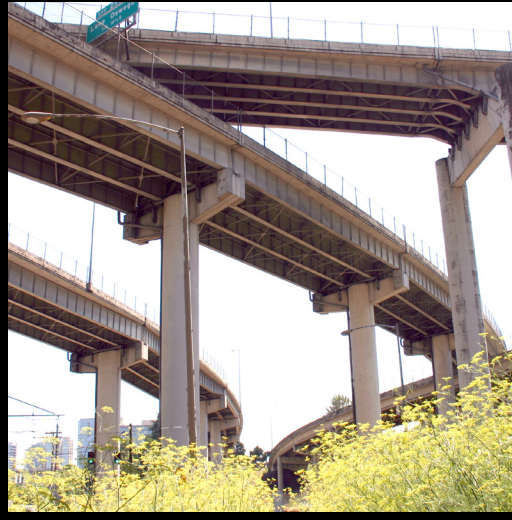

taipei

portland

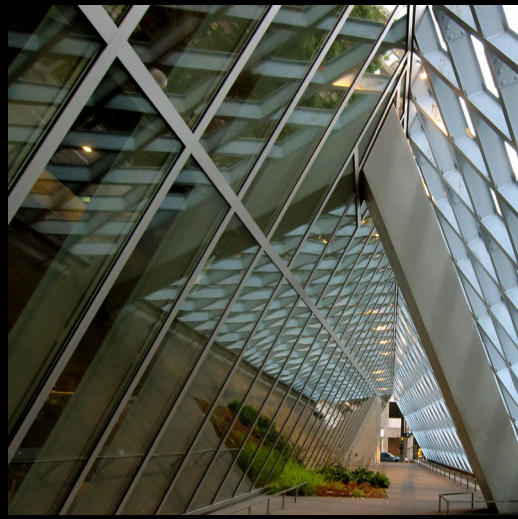

seattle

taipei

portland

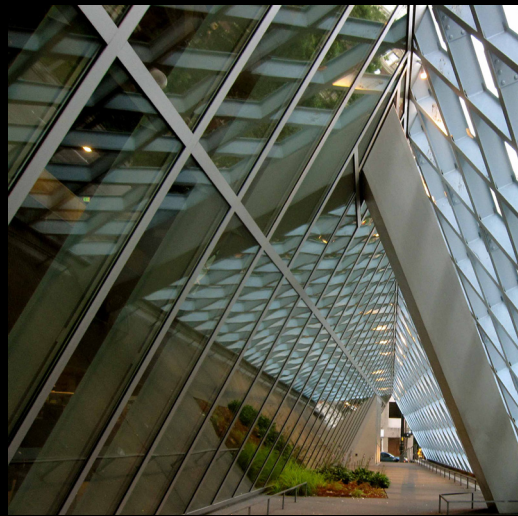

seattle

los angeles



# city explorations

The best way to get to know a city  
is to walk it  
drive it  
bus it  
sit in it  
spend in it  
use it  
and be a part of it.

One can never fully “know” a city, even through habitation or occupation. Cities are dynamic, growing, evolving places, undergoing urban revision, renewal, and change.

Even if the physical environment appears to stand still, the occupations and habits of the users - the people, the citizens - can change the dynamic of a place by changing how they use the space.

What follows is an initial collection of thoughts, ideas, images, and recordings from wandering through and observing several world cities. Each visit and exploration gives new insight to great urban form, urban systems, urban design, and the role of landscape architecture and landscape urbanism in cities.

precedents: other websites.

**THE AMERICAN INSTITUTE OF ARCHITECTS**

Home | Practice Activities | Current Students | Careers & Entry | Issues Advocacy | Success | Other Organizations

**Design Matters**

Member Matters

Special Report: Emerging Professionals

Architect Knowledge Resources

635 Eye Street NW  
Washington, DC 20001-2374  
United States of America  
Telephone: 1-202-638-2444  
Toll-Free Number: 1-888-999-ASLA (2752)  
Fax: 1-202-638-1182  
Email: info@aiia.org

**andropogon**

landscape architectural ecological planning & design

approach projects about us

balnori associates, inc. landscape and urban designers  
833 Washington St., 2nd fl.  
New York, NY 10014  
(between Little West 12th Street and Gansevoort Street \*map)  
t. 212.431.9191  
f. 212.431.8616  
info@balnori.com  
©2010 all rights reserved

**berão Swimming Pools / Pitagoras Arquitectos**

Latest Comments

Follow us on:

Facebook | Twitter | LinkedIn | YouTube | Flickr

**Buildings**

Featured | A-Z | Data Grid | Most Viewed

Support Earthquake Reconstruction in Haiti.

Find your next architect on Architizer

**AMERICAN SOCIETY OF LANDSCAPE ARCHITECTS**

MEMBER LOGIN

Green Since 1899

2010 Annual Meeting

2010 Professional Awards

Advocate to ASLA Members

Advocacy Network

Connect with ASLA

Designing Our Future Sustainable Landscapes

Green Roof

LAND e-Newsletter

Landscape Architecture Customized Education SYSTEM (CA CES)

Landscape Architecture Magazine (LAM)

Sustainable Sites Initiative

2010 General Design Honor Award

635 Eye Street NW  
Washington, DC 20001-2374  
United States of America  
Telephone: 1-202-638-2444  
Toll-Free Number: 1-888-999-ASLA (2752)  
Fax: 1-202-638-1182  
Email: info@aisla.org

**WORKING THE LINE**

Tomorrow night in Los Angeles, at the Center for Land Use Interpretation, David Taylor will be presenting his project "Working the Line."

**BLDG BLOG**

ARCHIVES

2010: August | July | June | May | April | March | February | January

2009: December | November | October | September | August | July | June | May | April | March | February | January

2008: December | November | October | September | August | July | June | May | April | March | February | January

2007: December | November | October | September | August | July | June | May | April | March | February | January

2006: December | November | October | September | August | July | June | May | April | March | February | January

2005: December | November | October | September | August | July | June | May | April | March | February | January

2004: August | July

ABOUT BLDGBLOG

**A Daily Dose of Architecture**

(Almost) daily architectural musings and imagery from New York City

Monday, August 02, 2010

31 in 1 series: #2

My Weekly Page

My Bookmarks

**dwelL**

JOIN | SIGN IN | MAGAZINE | CONFERENCE | BLOGS | DESIGN DESK

Today at Dwell

Product » Eadie Armchair

Event Spotlight » Dreamlands

Finishing Touch » Flemish Farmhouse Kitchen

Editor's Picks

Architecture » Smaller in Texas

Watch »

**inhabitat**

design will save the world

ARCHITECTURE INTERIORS PRODUCTS TECHNOLOGY ENERGY

**ENERGY**

Fossil Fuels Receive 12X More Subsidies Than Renewables

by Cameron Scott, 08/03/10

**landscapE + urbanism**

from landscape architecture to landscape urbanism

Restoring the Garden of Eden

MONROVIA

search over 2,300 plant varieties

livable city

livable city works to create a San Francisco of great streets and complete bicycling and transit are the best choices for most trips, where public spaces are well-maintained, and where housing is more plentiful and more affordable

**HARGREAVES ASSOCIATES**

San Francisco Cambridge New York London

Human Transit

monday multimedia meta

What is this blog about?

Categories

**morphopedia**

Home People Information News

Architecture

Urban Design

Exhibition

Product Design

Research

Books

Image Lighting

Office Webcams

All Webcams

**inhabitat**

design will save the world

ARCHITECTURE INTERIORS PRODUCTS TECHNOLOGY ENERGY

**ENERGY**

Fossil Fuels Receive 12X More Subsidies Than Renewables

by Cameron Scott, 08/03/10

**landscapE + urbanism**

from landscape architecture to landscape urbanism

Restoring the Garden of Eden

MONROVIA

search over 2,300 plant varieties

livable city

livable city works to create a San Francisco of great streets and complete bicycling and transit are the best choices for most trips, where public spaces are well-maintained, and where housing is more plentiful and more affordable

**HARGREAVES ASSOCIATES**

San Francisco Cambridge New York London

Human Transit

monday multimedia meta

What is this blog about?

Categories

**morphopedia**

Home People Information News

Architecture

Urban Design

Exhibition

Product Design

Research

Books

Image Lighting

Office Webcams

All Webcams

research: leading thinkers  
(a few books)

LANDSCAPE  
ARCHITECTURE

The  
Landscape  
Urbanism  
Reader

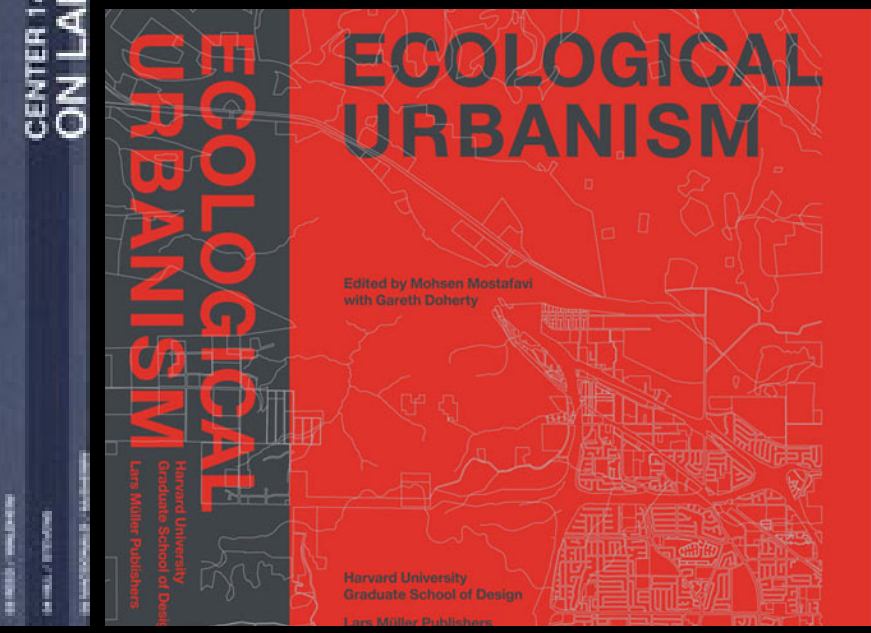
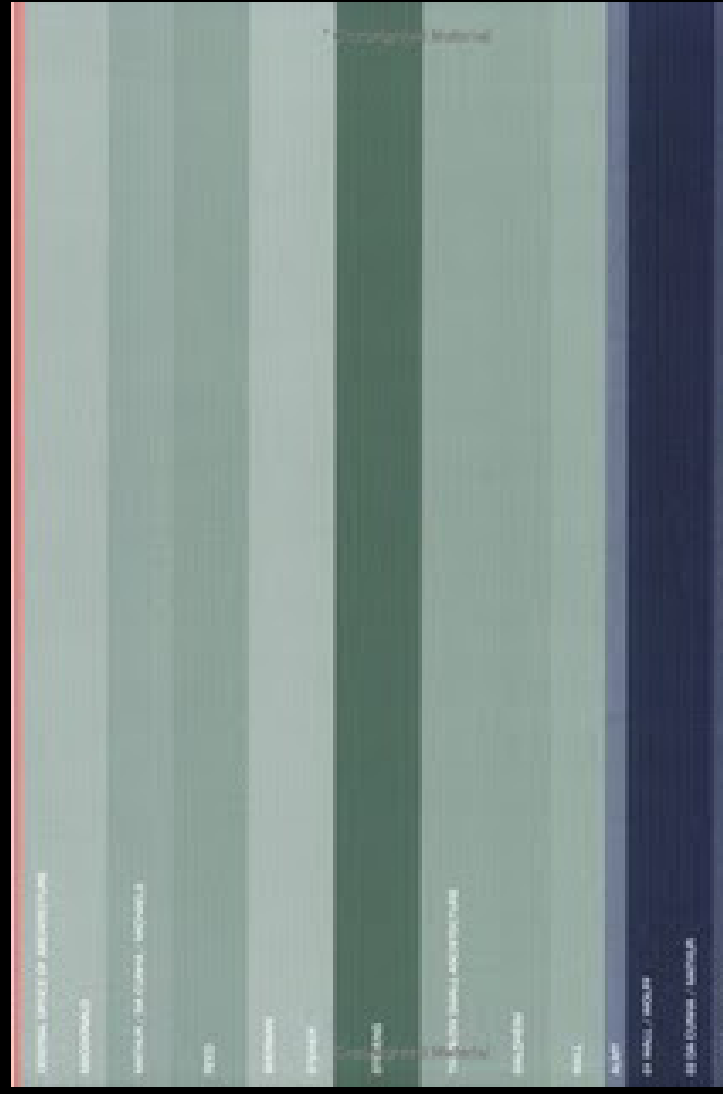
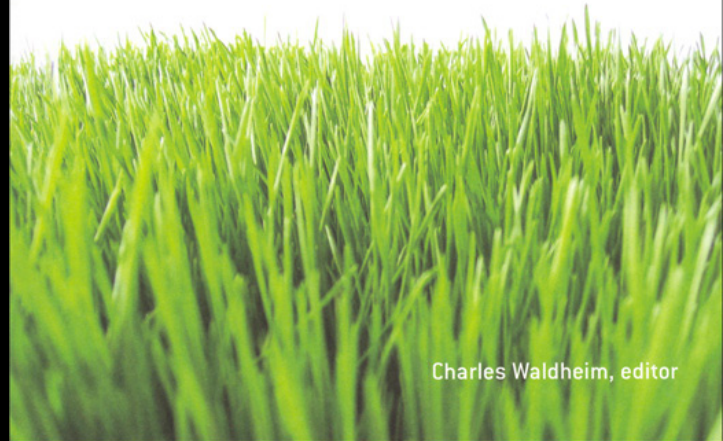
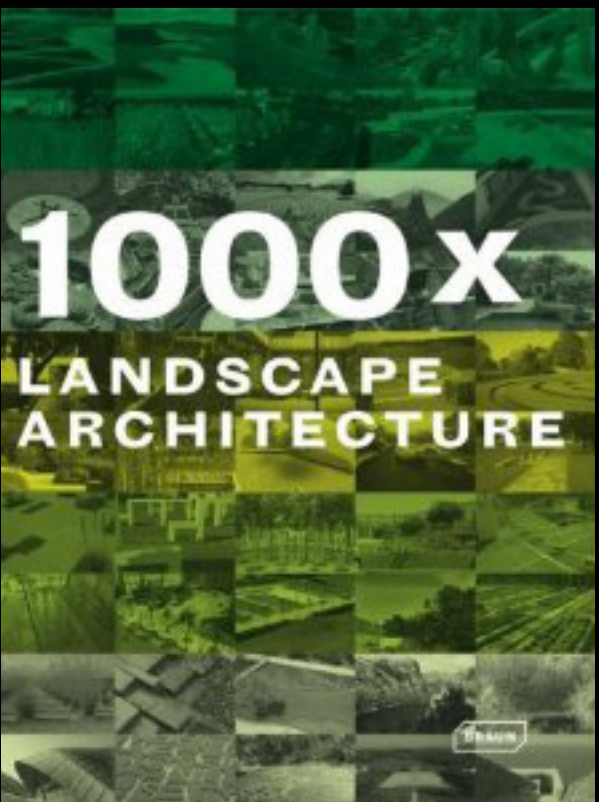
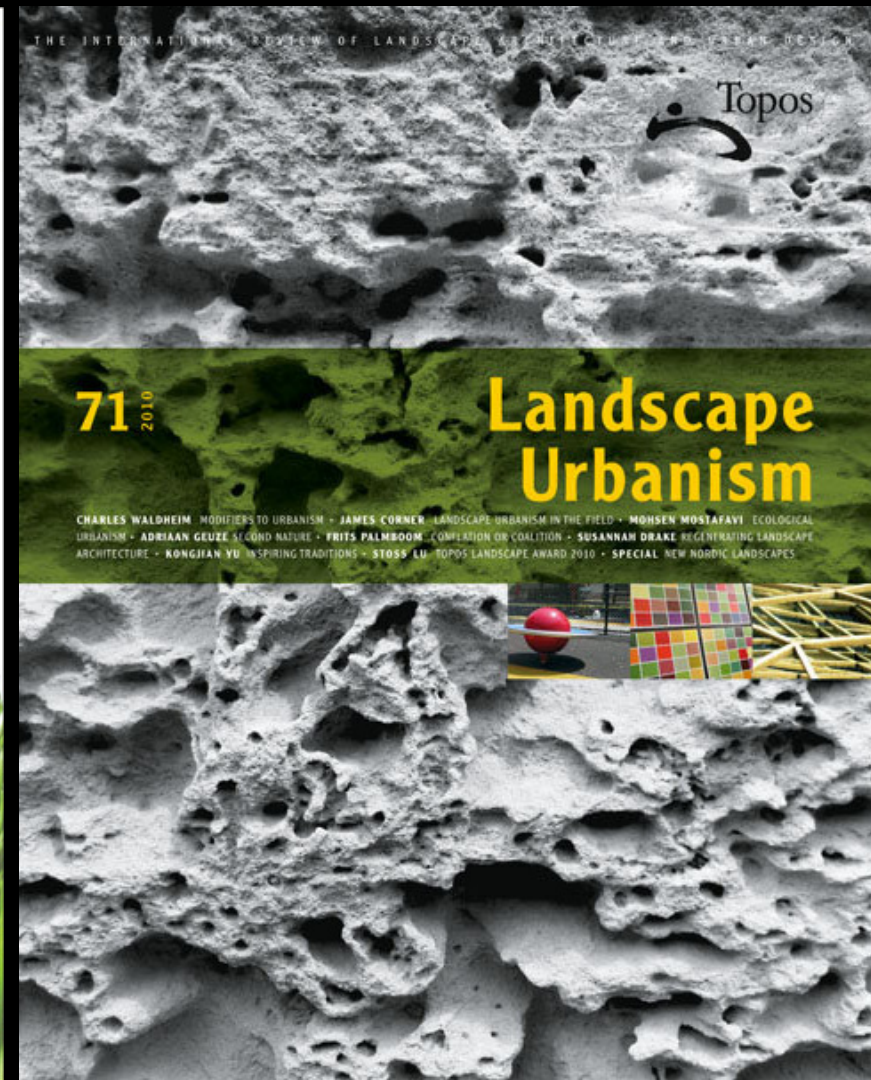

questions

what's "green"?



what stereotypes do we  
use when thinking about  
urban environments?



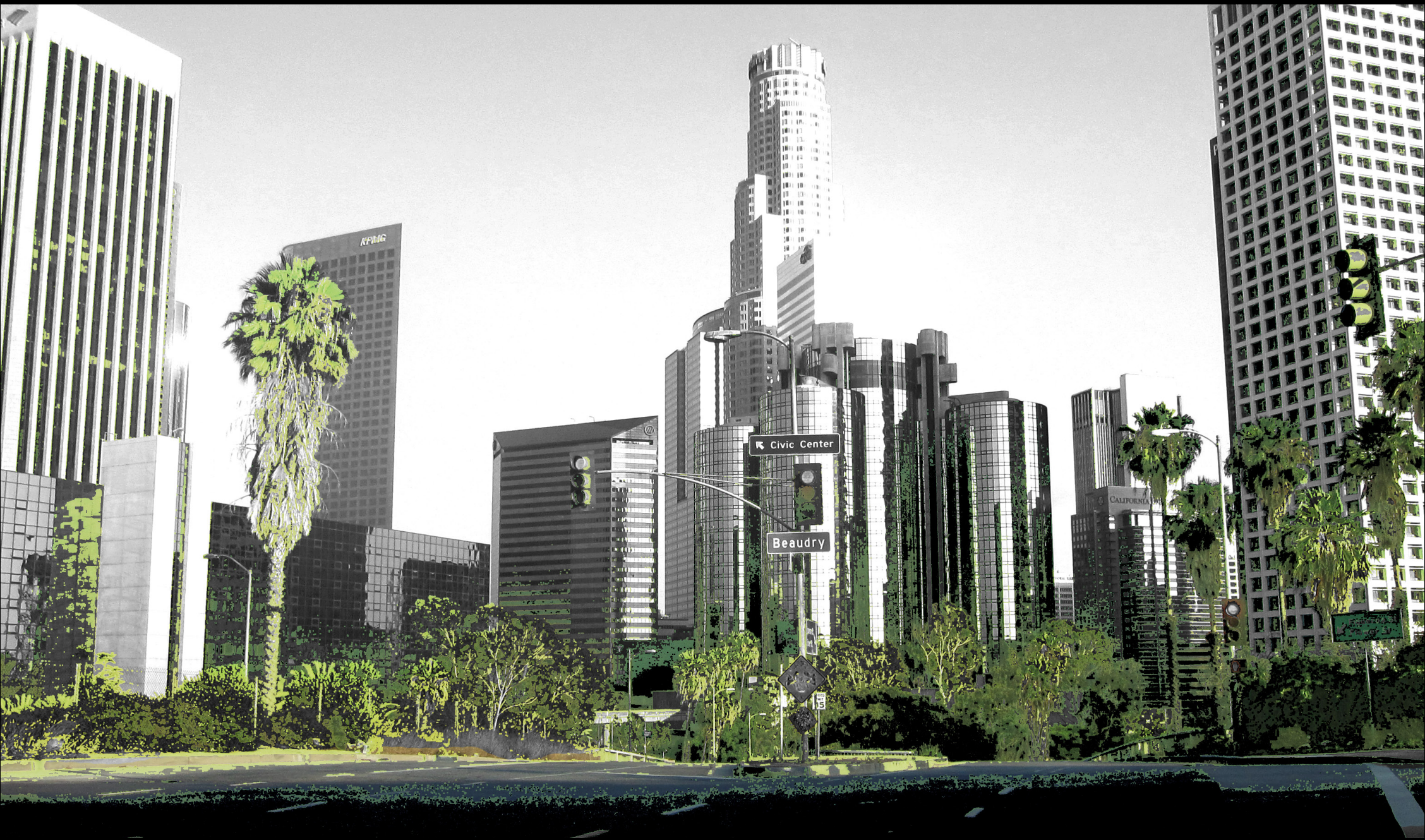

how do each of the urban components work in concert?



where does landscape start  
or stop? Where does it “fit”  
within and between the  
urban setting?

what color are the  
highways, if not “green”?



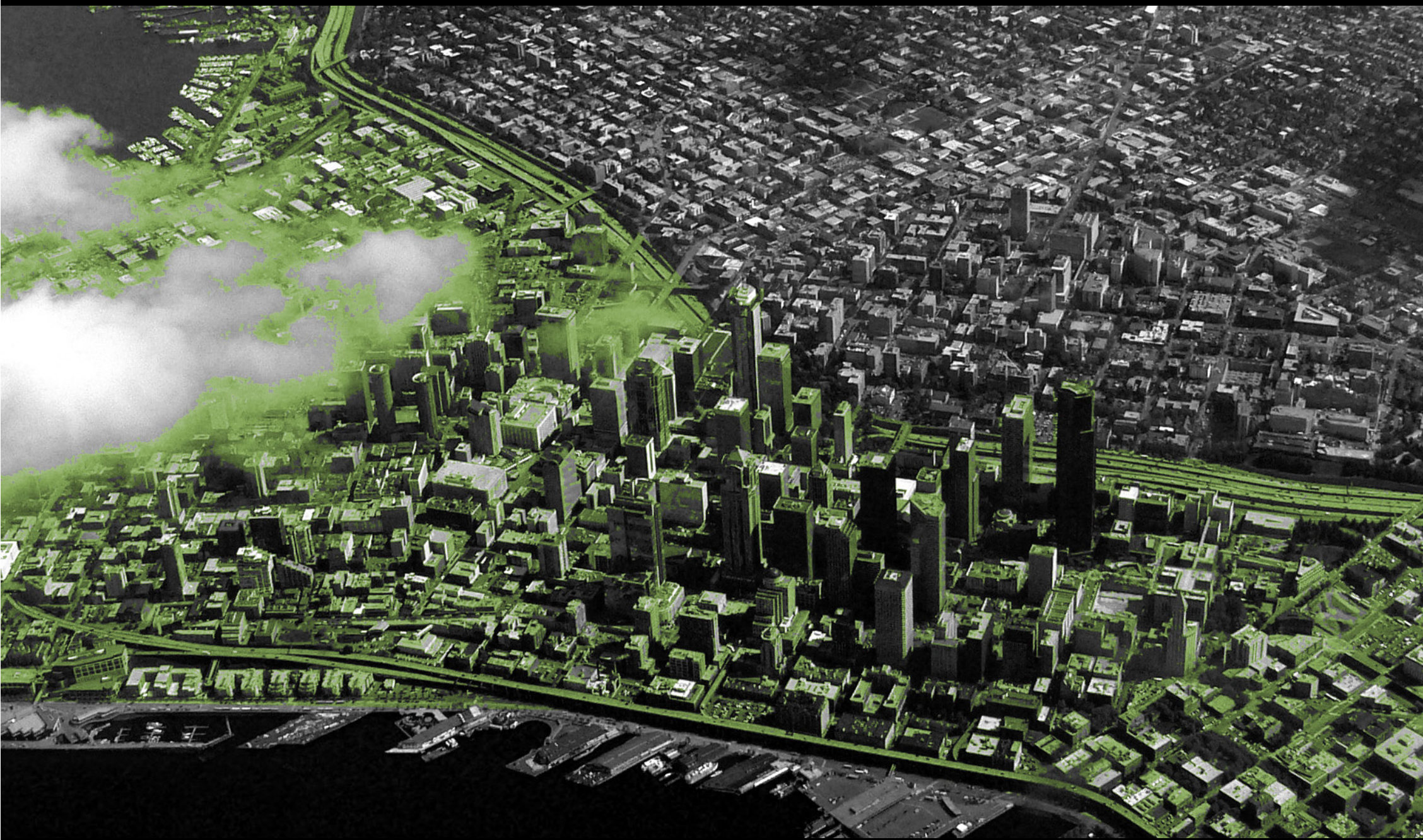

what becomes of the 20th  
century “downtown:” with  
continued urban expansion?

what physical elements will  
remain as we design to



meet new challenges of  
sustainable urban form?

where does landscape  
begin or end?





part 3: landscape urbanism.

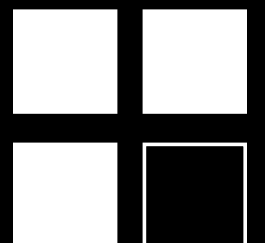

landscape architecture.

# “Landscape”



# “Landscape architecture”

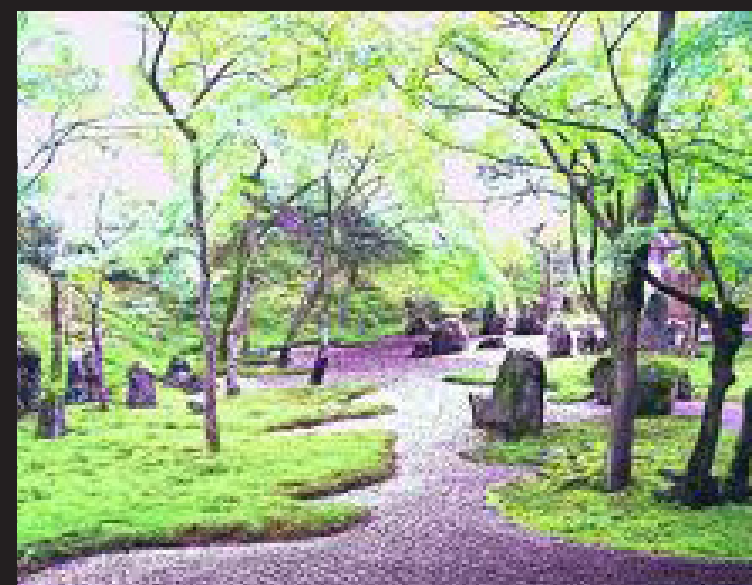
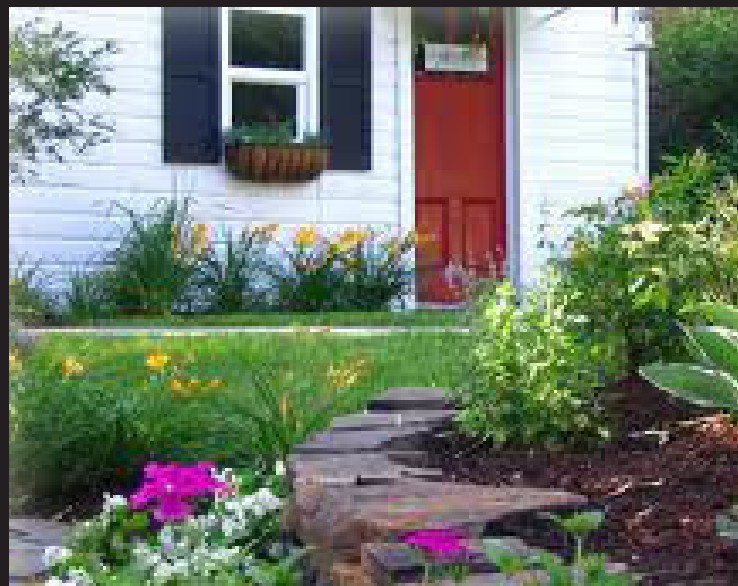

# “Landscape urbanism”

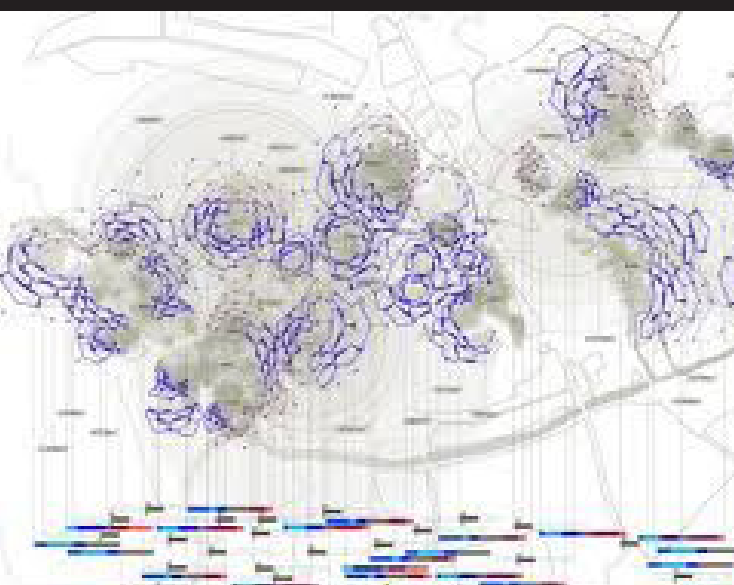
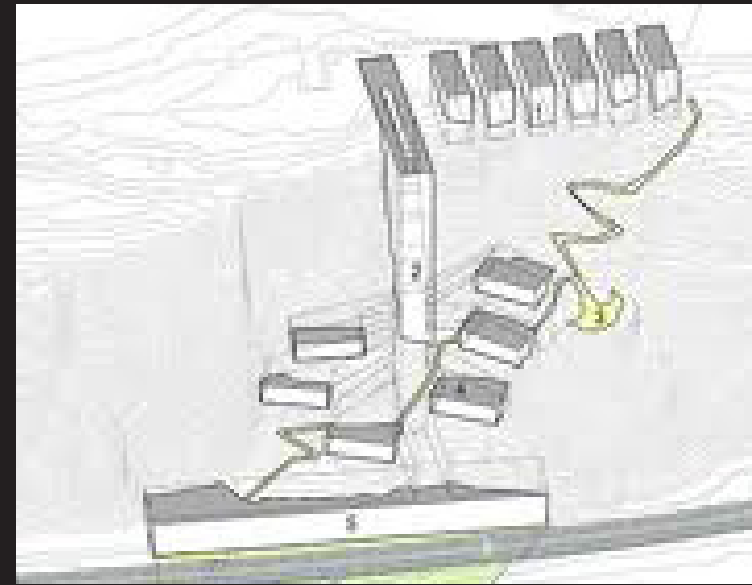

Landscape architecture.

**1828: Gilbert Laing Meason**  
"picturesque architecture"

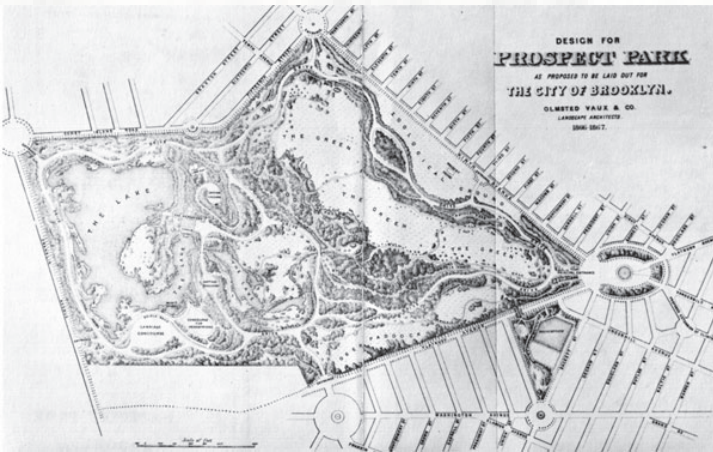

**1840: Loudon**

**1841: Andrew Jackson Downing**  
"A Treatise on the Theory and Practice of Landscape Gardening Adapted to North America."



Landscape architecture.

**1858: Olmsted and Vaux**

Used the term "landscape architect" in describing themselves to the Central Park Commission Board

**1899: ASLA**

Used the term to “strengthen the professional identity, education and authority of a group of designers with expertise in hydrology and drainage, agriculture, systemic botany, geology and soils, surveying and mapping, climate, sanitary engineering, horticulture, sociology, and architecture.”

**1900: Harvard**

degree in Landscape Architecture

**1910: ASLA Magazine founded**



LANDSCAPE  
ARCHITECTURE

A supplement to Landscape Architecture

**2010: Centennial ASLA issue**  
100 years of landscape architecture.

Landscape architecture: today.

**how is our field defined, received, and  
understood?**

“Even a century after the founding of the ASLA, the public often conflates landscape architecture with the work of gardeners and horticulturalists.”



**Susannah C. Drake, *Topos* 71, 2010**

“If a suburban lot is advertised as ‘landscaped,’ it is generally understood that somebody has fussed with the shrubbery on a bit of ground ... more or less artfully.”



**Peirce Lewis**  
**The Interpretation of Ordinary Landscapes, 1979**

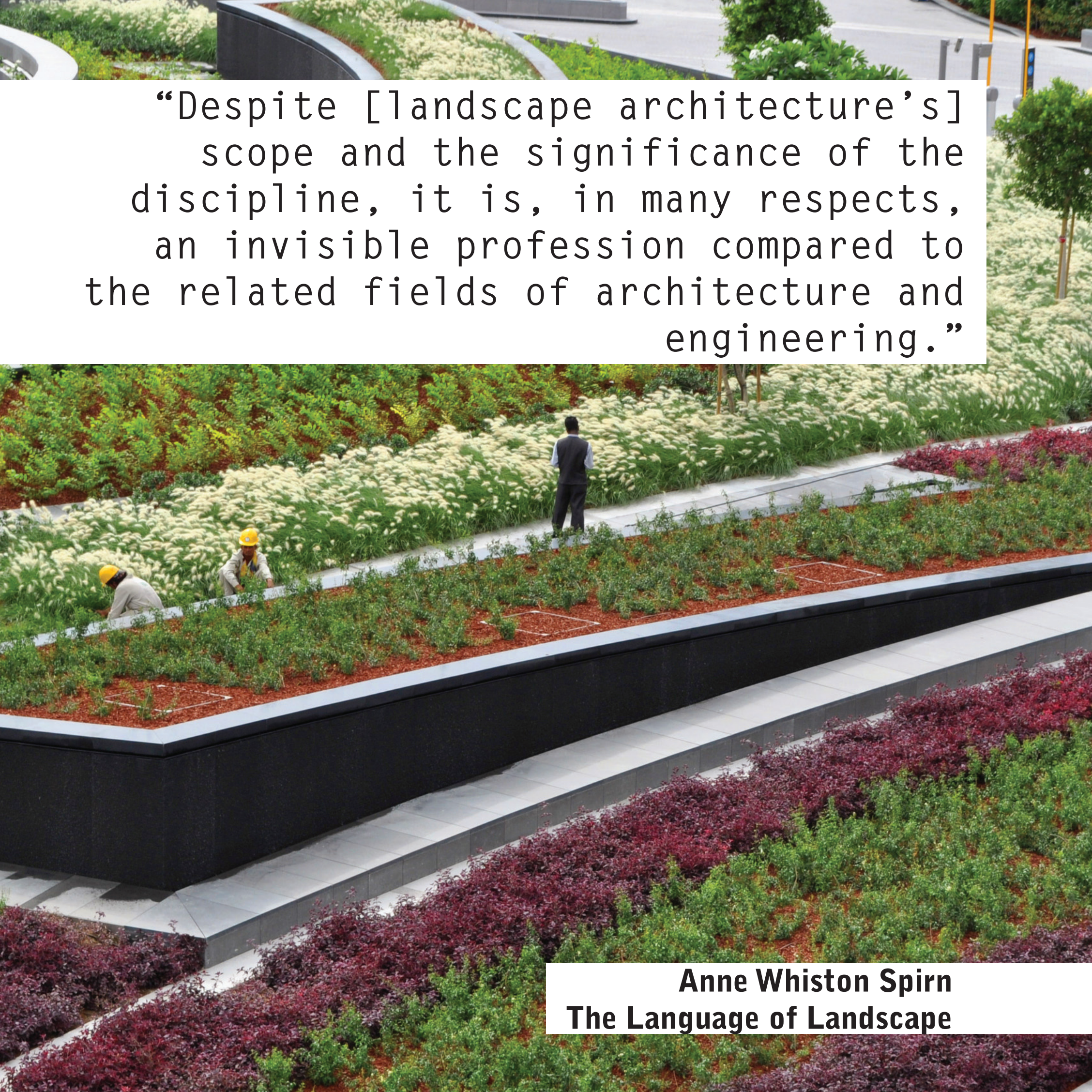

“Despite [landscape architecture’s] scope and the significance of the discipline, it is, in many respects, an invisible profession compared to the related fields of architecture and engineering.”

**Anne Whiston Spirn**  
**The Language of Landscape**

Landscape architecture  
is not “landscaping”

**why is this still a common misconception?**

problem of *definition*:  
what are we?

problem of *communication*:  
how do we tell people  
about what we do?

Landscape urbanism



Landscape urbanism seeks to:

“replace architecture as the backbone for cities”

“a disciplinary realignment currently underway in which landscape is replacing architecture’s historical role as the basic building block of city making.”

**Charles Waldheim**  
**The Landscape Urbanism Reader**

An aerial photograph of a modern urban park. A wide, paved walkway runs diagonally across the frame, flanked by raised planters filled with green grasses and shrubs. Several people are walking along the path. In the top left corner, a red sign with the word "GAP" is visible. The overall scene is bright and sunny, with long shadows cast across the pavement.

“The confluence of urbanism and landscape architecture . . . has given rise to Landscape Urbanism - a series of strategies for conceptualizing and restructuring urban environmental change while establishing a discipline in its own right.”

**Center 14:  
On Landscape Urbanism**

Highline Park, Field Operations

“Landscape urbanism proposes an alchemical relationship between the disciplines, one that is meant to be truly transformative in a tactical sense”



**Center 14:  
On Landscape Urbanism**

Seattle Sculpture Park, Weiss/  
Manfredi and Charles Anderson LA



“Landscape urbanism seeks to further the discipline of landscape architecture by giving it new meaning in the 21st century.”

**Charles Waldheim**  
**The Landscape Urbanism Reader**

After a century of work in  
landscape architecture, where  
landscape architecture was used to  
generate new cities and  
new urban spaces,

landscape urbanism now looks at  
both existing cities and new cities  
through the lens of landscape and  
ecological processes, seeking to use  
these principals and processes as the  
foundation for design.

Landscape urbanism seeks to “undo” the distinct separation between the disciplines of Urban Planning, Urban Design, Landscape Architecture, and Architecture) -

realizing that the processes of design that we’ve used over the last 40 years have not always worked.

Landscape urbanism: definitions

## Landscape urbanism: definitions

*Landscape urbanism embraces the human and environmental processes that influence city creation, development and longevity. In practice, landscape urbanism is the process of collaborative, complex decision-making about how physical space should be designed.*

# Landscape urbanism: definitions

*Landscape urbanism embraces the human and environmental processes that influence city creation, development and longevity. In practice, landscape urbanism is the process of collaborative, complex decision-making about how physical space should be designed.*

process • the process of design is dynamic and not static: a design is never finished; it only sets the stage for future occupation, change, inhabitation, and the dynamic complexity of a place.



# Landscape urbanism: definitions

*Landscape urbanism embraces the human and environmental processes that influence city creation, development and longevity. In practice, landscape urbanism is the process of collaborative, complex decision-making about how physical space should be designed.*

people • Landscape urbanism design is focused on people and the way people and landscape interact.



Los Angeles "CleanTECH" Competition

# Landscape urbanism: definitions

*Landscape urbanism embraces the human and environmental processes that influence city creation, development and longevity. In practice, landscape urbanism is the process of collaborative, complex decision-making about how physical space should be designed.*

sustainable systems • Landscape urbanism understands the need for sustainable, green design and the need for long-lasting landscape systems and structures.



# Landscape urbanism: definitions

*Landscape urbanism embraces the human and environmental processes that influence city creation, development and longevity. In practice, landscape urbanism is the process of collaborative, complex decision-making about how physical space should be designed.*

flexible • Landscape urbanism design is flexible, adaptable, and changing over time.



Field Operations "Fresh Kills"

# Landscape urbanism: definitions

*Landscape urbanism embraces the human and environmental processes that influence city creation, development and longevity. In practice, landscape urbanism is the process of collaborative, complex decision-making about how physical space should be designed.*

time + space • Landscape urbanism moves beyond form in space, to looking at form and process in space over time.

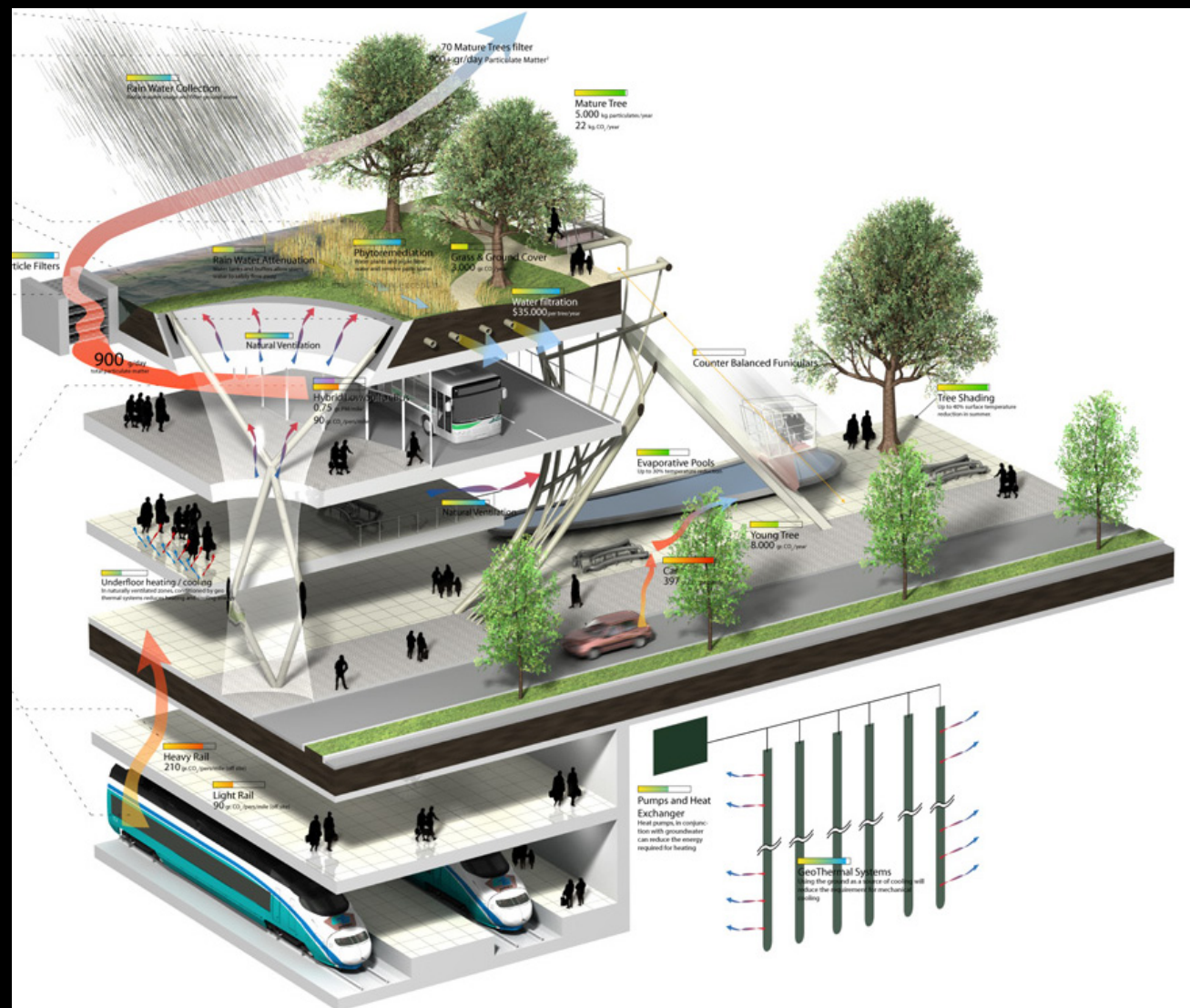

“Except” Architecture Renderings

# Landscape urbanism: definitions

*Landscape urbanism embraces the human and environmental processes that influence city creation, development and longevity. In practice, landscape urbanism is the process of collaborative, complex decision-making about how physical space should be designed.*

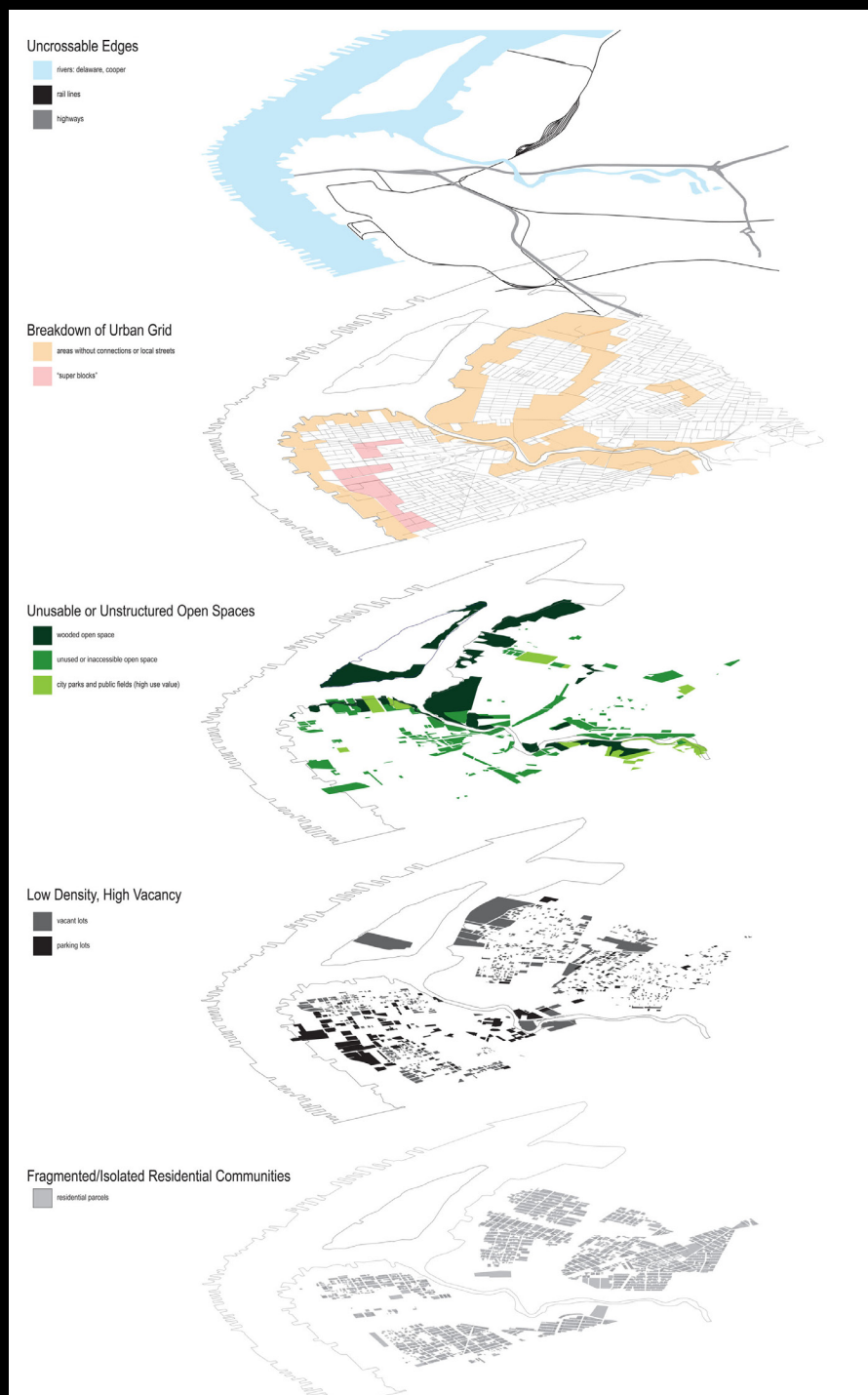

systems  
interaction

•  
Landscape urbanism  
looks at the individual  
components and the critical  
intersections/interactions  
between design elements  
that create an exciting and  
dynamic city.

# Landscape urbanism: definitions

*Landscape urbanism embraces the human and environmental processes that influence city creation, development and longevity. In practice, landscape urbanism is the process of collaborative, complex decision-making about how physical space should be designed.*

**contextual** • Landscape urbanism is contextual: it respects and reveals the history and personality of a place.



Los Angeles "CleanTECH" Competition (runner up)

# Landscape urbanism: definitions

*Landscape urbanism embraces the human and environmental processes that influence city creation, development and longevity. In practice, landscape urbanism is the process of collaborative, complex decision-making about how physical space should be designed.*

place • Landscape urbanism is about creating a sense of place.



Hangzhou Hubin Waterfront, SWA Group

# Landscape urbanism: definitions

*Landscape urbanism embraces the human and environmental processes that influence city creation, development and longevity. In practice, landscape urbanism is the process of collaborative, complex decision-making about how physical space should be designed.*

inter •  
disciplinary

Landscape urbanism reflects a collaborative design process whereby many different fields work in concert to create, modify, and design urban environments.



landscape urbanism: vision

# landscape urbanism: vision

“In practical terms, landscape urbanism elevates the role of the landscape architect to that of the master choreographer, the great generalist who is able to see and shape enormously complex phenomena into new organizations.

Cross-disciplinary, inclusive and visionary, the landscape urbanist is perhaps the best hope cities have for coping with increased densification, V[\_[`[eZVW resources and Wh[da`\_WfS^ decline.

No longer the consultant brought in at the end of a project to add greenery, the landscape urbanist is now at the forefront of conceiving and leading new complex forms of urban planning, development, and design.”

Jim Corner

Landscape Urbanism in the Field

Landscape urbanism: the backstory

“Our large cities are so young that their beauty is yet to be wholly discovered.”



**August Endell, 1908:  
From “The Beauty of the Big City”**

“Give the city a small piece of the  
love you give to the countryside”

— Franz Hessel 1880-1941  
From Center 14: On Landscape Urbanism

why landscape urbanism.

Sean O'Malley  
SWA Group

“The city is the ultimate expression of man; we must understand what the land can tell us, so that we can ensure the survival of both our natural systems and civilization itself.”

Ying-Yu Hung  
SWA Group

“Landscape architecture has become a meta discipline that guides other disciplines - one that protects the resources of the world and sets strategies to curtail global warming, to augment habitats for endangered species, and to minimize the human footprint.”

“\_\_\_\_\_” urbanism

critiques

# SCALE

“The jargon, synthetic words and intractable sentences are essentially a response to the complexity of what authors want to tackle: the entire urban scene.”

**C. Gray, Turning the Field: Contradictions in  
Landscape Urbanism  
From Landscape Urbanism - Kerb 15**

## NEW “NEW URBANISM”

“Landscape urbanism emerged over the past decade as a critique of the disciplinary and professional commitments of traditional urban design and an alternative to “New Urbanism.”

..Urban design has yet to fulfill its potential as an intersection of the design disciplines engaging with the built environment.

Urban design ought to concentrate less attention on mythic images of a lost <sup>Yan</sup> age of density and more attention to the urban conditions where most of us live and work.

# PRACTICE

“It may be true that the urban form proposed by landscape urbanism has not yet fully arrived.”

“[But] it would be equally fair to say that landscape urbanism remains the most promising alternative available to urban design’s formation for the coming decades. This is in no small part due to the fact that landscape urbanism offered a culturally leavened, ecologically literate, and economically viable model for contemporary urbanization as an alternative to urban design’s ongoing nostalgia for traditional urban forms.

One evidence of this is the number of internationally prominent landscape architects who have been retained as lead designers of large-scale urban development proposals in which landscape offers ecological function, cultural authority, and brand identity.

**Charles Waldheim**  
**Topos 71: Landscape Urbanism, 2010**



part 4: the website.

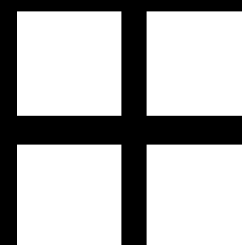

a website for

landscape architects  
architects  
planners  
urbanists  
designers  
students  
professionals  
clients  
thinkers  
journalists  
people

+

all things urban + landscape

# 2010 landscape urbanism project

week 1

explorations: 4 cities  
taipei, portland, seattle, los angeles

week 2

research + reading  
annotated bibliography

1: Ying-Yu & Gerdo

week 3

website + template design  
iterations of design  
content structure + framework

2: Elizabeth + Josselyn

3: Blink Tag, Inc

week 4

presentation design  
Nancy Duarte: SLIDE\_OLOGY, RESONATE

4: Ying-Yu & Gerdo

▶ presentation

5: SWA Principals Meeting

website coding + launch

content build-out

contacts: get involved

funding + financing

maintenance.  
collaboration.



## next steps

Jan 2011

### launch beta site

platform testing + coding  
initial pages + content build out

Feb 2011

### contacts + collaboration

students + universities: are there  
partner universities we can  
collaborate with?  
firms + practices: contact 10-15  
firms for initial content; generate  
submission forms  
blogs + rss feeds

Mar 2011

### call for submissions

essays - call for submissions:  
post online

next steps

Dec 2010  
- Feb 2011

funding + financing

Graham Foundation  
Rockefeller Foundation  
Other grants, funding and fellowships

Jan 2011

landscape urbanism primer

annotated illustrated bibliography

summer  
2011

university collaboration

partner university  
local presentations

2010 landscape urbanism project

appendix a: building a website  
appendix b: design iterations +  
precedents  
appendix c: notes + sketches

## Error 404--Not Found

From RFC 2068 *Hypertext Transfer Protocol -- HTTP/1.1*:

### 10.4.5 404 Not Found

The server has not found anything matching the Request-URI. No indication is given of whether the condition is temporary or permanent.

If the server does not wish to make this information available to the client, the status code 403 (Forbidden) can be used instead. If the server knows, through some internally configurable mechanism, that an old resource is permanently unavailable and has no forwarding address, it should use status code 410 (Gone).

# Maintenance Mode

[landscape urbanism](#) is currently undergoing design and development.

Please try back again soon.

Sorry for the inconvenience. Come back this fall!



The Maintenance Mode is active.

Username

Password

Remember Me

[Log In](#)

[Lost your password?](#)

- Dashboard
- Dashboard
  - Updates 3
  - Akismet Stats
- Posts
- Media
- Links
- Pages
- Projects
- Essays
- Comments
- Appearance
  - Themes
  - Widgets
  - Menus
  - Background
  - Header
  - Editor
- Plugins 3
  - Plugins
  - Add New
  - Editor
  - Akismet Configuration
- Users
  - Users
  - Add New
  - Your Profile
- Tools
  - Tools
  - Import
  - Export
  - Rebuild Thumbnails
- Settings

# Dashboard

The Maintenance Mode is active. Please don't forget to [deactivate](#) it as soon as you are done.

## Right Now

Content	Discussion
3 Posts	1 Comment
9 Pages	0 Approved
6 Categories	0 Pending
0 Tags	1 Spam

Theme **Landscape Urbanism** with **10 Widgets** [Change Theme](#)

You are using **WordPress 3.0.1**.

Akismet blocks spam from getting to your blog, and there's **1 comment** in your spam queue right now.

## Recent Comments

No comments yet.

## Incoming Links

This dashboard widget queries [Google Blog Search](#) so that when another blog links to your site it will show up here. It has found no incoming links... yet. It's okay — there is no rush.

## Plugins

Loading...

## Google Analytics Summary



Site Usage

## QuickPress

Loading...

## Recent Drafts

- [article about landscape urbanists](#) September 13, 2010  
<http://www.washingtonpost.com/wp-dyn/content/article/2010/09/10/AR2010091000469.html>
  - [los angeles\\_getty museum](#) July 30, 2010
- [View all](#)

## WordPress Development Blog

- [WordPress for iPhone/iPad v2.6 Released](#) September 30, 2010  
Attention Apple-gadget-owning WordPress users! Have you been using the WordPress iOS app for iPhone and iPad? Or maybe you tried it a while back and thought it wasn't for you? Either way, the new release — v2.6 — will knock your socks off. Why? A bunch of reasons: Video. Record, upload, attach, and play videos [...]
- [WordPress Trademark Changes Hands](#) September 9, 2010  
The WordPress community took a big step forward today when Matt announced that Automattic has donated the WordPress trademark to the non-profit WordPress Foundation. Moving forward, the Foundation will be responsible for safeguarding the trademarked name and logo from misuse toward the end of protecting WordPress and preventing confusion among people trying [...]

## Other WordPress News

```
style.css - Notepad
File Edit Format View Help
/*
Theme Name: Landscape Urbanism
Theme URI:
Description: Child Theme for Twentyten
Author: BlinkTag Inc.
Author URI: http://blinktag.com
Template: twentyten
Version: 2.0
*/

/* =Reset default browser CSS. Based on work by Eric Meyer: http://meyerweb.com/eric/tools/css/reset/index.html
----- */

html, body, div, span, applet, object, iframe,
h1, h2, h3, h4, h5, h6, p, blockquote, pre,
a, abbr, acronym, address, big, cite, code,
del, dfn, em, font, img, ins, kbd, q, s, samp,
small, strike, strong, sub, sup, tt, var,
b, u, i, center,
dl, dt, dd, ol, ul, li,
fieldset, form, label, legend,
table, caption, tbody, tfoot, thead, tr, th, td {
    background: transparent;
    border: 0;
    margin: 0;
    padding: 0;
    vertical-align: baseline;
}
body {
    line-height: 1;
}
h1, h2, h3, h4, h5, h6 {
    clear: both;
    font-weight: normal;
}
ol, ul {
    list-style: none;
}
blockquote {
    quotes: none;
}
blockquote:before, blockquote:after {
    content: '';
    content: none;
}
del {
    text-decoration: line-through;
}
/* tables still need 'cellspacing="0"' in the markup */
table {
    border-collapse: collapse;
    border-spacing: 0;
}
a img {
    border: none;
}

/* =Layout
----- */

/*
LAYOUT: Two columns
DESCRIPTION: Two-column fixed layout with one sidebar right of content
*/
#container {
    float: left;
    margin: 0;
    width: 100%;
}
```

**FileZilla** Landscape Urbanism - lscape@www.landscapurbanism.com - FileZilla  
 File Edit View Transfer Server Bookmarks Help

Host:  Username:  Password:  Port:  Quickconnect

```

Command: TYPE I
Response: 200 TYPE is now 8-bit binary
Command: PASV
Response: 227 Entering Passive Mode (174,132,139,133,253,255)
Command: MLSD
Response: 150 Accepted data connection
Response: 226-Options: -a -l
Response: 226 22 matches total
Status: Directory listing successful
  
```

Local site: \ Remote site: /

Filename	Filesize	Filetype	Last modified	Permissions
C:		Local Disk		
D: (DATAPART1)		Local Disk		
E:		CD Drive		
L: (\\SAU1FS001\...)		Network Drive		
O: (\\SAU1FS001\...)		Network Drive		
P: (\\SAU1FS001\...)		Network Drive		
Q: (\\SAU1AP801\...)		Network Drive		
T: (\\SAU1AP801\...)		Network Drive		

Filename	Filesize	Filetype	Last modified	Permissions
..		File Folder	7/16/2010 3:15:07 PM	0750
.htpasswd		File Folder	7/16/2010 3:15:07 PM	0755
etc		File Folder	7/16/2010 3:15:07 PM	0750
public_ftp		File Folder	7/16/2010 3:15:07 PM	0777
www		File Folder	7/16/2010 3:15:07 PM	0777
access-logs		File Folder	7/16/2010 3:17:25 PM	0755
tmp		File Folder	7/16/2010 3:17:25 PM	0700
.cpanel		File Folder	7/16/2010 3:20:30 PM	0755
.infobox		File Folder	7/16/2010 3:22:36 PM	0750
.fantasticodata		File Folder	8/27/2010 4:14:02 PM	0750
mail		File Folder	10/14/2010 12:01:01 PM	0644
public_html		File Folder	7/16/2010 3:15:07 PM	0644
.bash_logout	24	BASH_LOGOUT File	7/16/2010 3:15:07 PM	0644
.bash_profile	191	BASH_PROFILE File	7/16/2010 3:15:07 PM	0644
.bashrc	124	BASHRC File	7/16/2010 3:15:07 PM	0644
.canna	5,619	CANNA File	7/16/2010 3:15:07 PM	0600
.contactemail	18	CONTACTEMAIL File	7/16/2010 3:15:07 PM	0644
.emacs	383	EMACS File	7/16/2010 3:15:07 PM	0644
.zshrc	658	ZSHRC File	7/16/2010 3:15:07 PM	0644
.gemrc	124	GEMRC File	7/16/2010 3:15:14 PM	0600
.lastlogin	14	LASTLOGIN File	7/16/2010 3:23:36 PM	0644

8 directories | 9 files and 11 directories. Total size: 7,155 bytes

Server/Local file | Direction | Remote file | Size | Priority | Status

# Projects Manage Themselves with Basecamp.

Millions of people use Basecamp, the leading online project collaboration tool.



Basecamp is the top choice for entrepreneurs, freelancers, small businesses, and groups inside big organizations.



**R.BIRD**  
Brand design firm



**Elsewares**  
Independent art retailer



**Atelier**  
High-end wedding planner



Over **5 million people** worldwide have used Basecamp to collaborate on over **4 million projects**, track **57 million hours** of work, share **46 million files**, and complete **43 million to-dos**. How will you use Basecamp?

~~appendix a: building a website~~  
appendix b: design iterations +  
precedents  
appendix c: notes + sketches

home  
about  
contact

# LANDSCAPE URBANISM

HOME NEWS ESSAYS PROJECTS CITIES RESOURCES

about this site   
what is landscape urbanism?   
get involved 

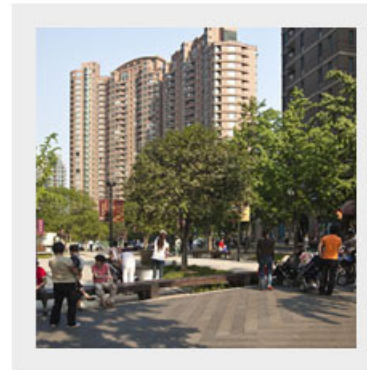



# LANDSCAPE URBANISM

HOME NEWS ESSAYS PROJECTS CITIES RESOURCES

## news

---

Related news from around the internet.

Edit

 BLDGBLOG

[A form of dying, losing contact with the city like that](#)

November 8, 2010

New Yorkers, don't miss a live conversation taking place tomorrow night—Tuesday, November 9, the 21st anniversary of the fall of the Berlin Wall—on the subject of "Cities." Moderated by Mark Wigley, the discussion features Robert Krulwich, science correspondent for NPR and co-host of Radiolab; Lewis Lapham, founder and editor of Lapham's Quart [...]

[Liquid Radio](#)

November 8, 2010

Could temporary jets of seawater be used as functioning radio antennas? Apparently so: as PopSci reports, "communications are vital" for vessels at sea, but deck space for "all the large antennas necessary for long-range (and often encrypted) communications" can be hard to come by. "So U.S. Navy R&D lab SPAWAR Systems Center Paci [...]

 Next American City

[The Braddock Story](#)

November 8, 2010

An old dentist's office on Braddock's main drag. Credit: Clark MizonoA recent Levi's ad features a child reading a poem about frontiers, and shots of Levi's-clad people working to repair damaged buildings in a depressing-looking town. That town is the borough of Braddock, PA, located just outside of Pittsburgh. It has gotten a lot of press lately from outlet [...]

[Who's Scared of a Transit Bridge?](#)

November 8, 2010

A rendering of the proposed bridge. Local politicians and planners in Portland want commuters to keep their cars at the curb, and they're calling on "Godzilla" for help. Next spring, Portland will begin building its first bridge over the Willamette River in 37 years. The Willamette River Transit Bridge — which will link a future Oregon Health & Science U [...]



# LANDSCAPE URBANISM

[HOME](#) [NEWS](#) [ESSAYS](#) [PROJECTS](#) [CITIES](#) [RESOURCES](#)

[SUBMIT A PROJECT](#)

## PROJECTS BY CATEGORY

[NEW CITIES](#)  
[PARKS + TRAILS](#)  
[URBAN DESIGN](#)

## projects





Like Melinda McMillan and 109,940 others like this.

# Ribeirão Swimming Pools / Pitagoras Arquitectos

03  
AUG 2010

By Nico Saieh — Filed under: Selected, Sports Architecture, Concrete, Pitagoras Arquitectos, Portugal, Wood

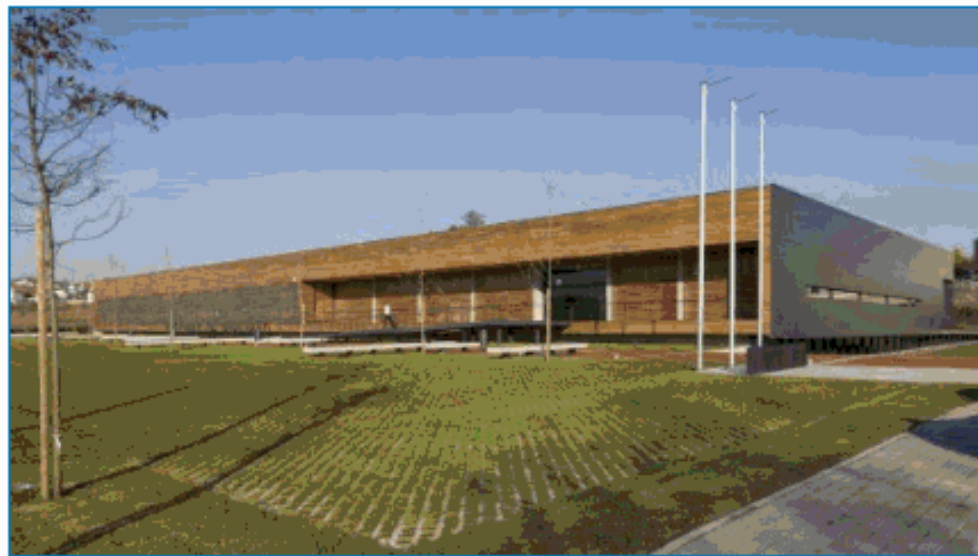

© Luis Ferreira Alves

Architects: **Pitagoras Arquitectos**  
 Location: **Ribeirão, Vila Nova De Famalicão, Portugal**  
 Principals: **Fernando Seara de Sá, Raul Roque Figueiredo, Alexandre Coelho Lima, Manuel Vilhena Roque**  
 Collaborators: **Fernando Torres, Marlene Sousa, Francisco Oliveira, Hélio Pinto**  
 Promotor: **Município de Vila Nova De Famalicão**  
 Project Year: **2004-2008**  
 Photographs: **Luis Ferreira Alves**



[read more »](#)

Share: Comment / 1 Tweet »

**Modern SF Architect**  
 Need an Experienced Architect? Call For a Consultation Today.  
[www.Group41Inc.com](http://www.Group41Inc.com)

**Faulkner Architects**  
 Fine custom private residences Highly Crafted, Sustainable Design  
[FaulknerArchitects.com](http://FaulknerArchitects.com)

## Featured



Google Custom Search  Search  
 4139 posts, 76416 comments, 821 days.

## Latest Comments »

- Kris on [WTC Transit Hub / Santiago Calatrava](#): \$3.2 Billion, I suppose they could have a fancy-schmancy animation like that....[+]
- le Mies van der Wright on [Peoples Bank of the South / Sanders Pace Architecture](#): Ah....Sanders and Pace have done it...[+]
- ozmoto on [Aritt Farmhouse / OnSite Architecture](#): Oh... and the building glows at night like historic leaning buildings...[+]
- boss on [Diagonal 80 / AMID \(Cero9\)](#): casa de musica and this project are not similar at all. period.[+]
- Patricia on [Diagonal 80 / AMID \(Cero9\)](#): Very similar (from outside) to Casa Musica OMA in Porto..For me: too similar.....[+]
- Frank on [The New Domino / Rafael Mñoly Architects](#): Nice site to earn a lot of money. If these towers were made blue and...[+]
- Flick on [WTC Transit Hub / Santiago Calatrava](#): Love it! Want to see more![+]
- Axe on [Floating Dining Room / Goodweather Design & Loki Ocean](#): Wouldn't call it "great", I like it...[+]
- MyMorningJoe on [Tangga House / Guz Architects](#): I was writing about this home earlier today and I have to say it is one of the...[+]
- unlikelymoose on [We want your opinion, we want your feedback](#): archdaily.com is the ultimate powerhouse of displaying the...[+]

## Follow us »

enter your email for daily updates

## Upcoming Architecture Events »

- "Chi-rrette": Ladies Competition [read more »](#)
- The Spirit in Architecture [read more »](#)

## Our partners »



## Browse by keyword »

- AD Project Insights
- Australia Austria Brazil
- Brick California Canada
- Chile **China**
- Concrete**
- Denmark France
- Germany Glass Italy
- Japan Mexico Mixed
- Use New York
- Norway Ordos 100
- Portugal Shanghai
- 2010 Slovenia **Spain**
- Steel** Stone The
- Netherlands
- USA Wood**





## WORKING THE LINE

Tomorrow night in Los Angeles, at the Center for Land Use Interpretation, David Taylor will be presenting his project "[Working the Line](#)."



[Image: U.S./Mexico border marker #184; photograph by [David Taylor](#)].

Taylor has been documenting "276 obelisks, installed between the years 1892 and 1895, that mark the U.S./Mexico boundary from El Paso/Juarez to San Diego/Tijuana. He will present this work, and describe his experiences along this often remote and dramatic linear and liminal space."

As geographer [Michael Dear](#)—who spoke about border issues back at [Postopolis! LA](#)—describes these obelisks:

The monuments erected by the boundary survey played a pivotal role in securing the line after the Mexican-American War. These obelisks and stone mounds literally marked on the ground the southernmost edges of the nation; they became fundamental points of reference in subsequent boundary disputes (of which there were many) and in the resurvey of the border that took place at the end of the 19th century.

# BLDG BLOG

## ARCHIVES

2010: [August](#) | [July](#) | [June](#) | [May](#) | [April](#) | [March](#) | [February](#) | [January](#)

2009: [December](#) | [November](#) | [October](#) | [September](#) | [August](#) | [July](#) | [June](#) | [May](#) | [April](#) | [March](#) | [February](#) | [January](#)

2008: [December](#) | [November](#) | [October](#) | [September](#) | [August](#) | [July](#) | [June](#) | [May](#) | [April](#) | [March](#) | [February](#) | [January](#)

2007: [December](#) | [November](#) | [October](#) | [September](#) | [August](#) | [July](#) | [June](#) | [May](#) | [April](#) | [March](#) | [February](#) | [January](#)

2006: [December](#) | [November](#) | [October](#) | [September](#) | [August](#) | [July](#) | [June](#) | [May](#) | [April](#) | [March](#) | [February](#) | [January](#)

2005: [December](#) | [November](#) | [October](#) | [September](#) | [August](#) | [July](#) | [June](#) | [March](#) | [February](#) | [January](#)

2004: [August](#) | [July](#)

## ABOUT BLDGBLOG

ARCHITECTURAL CONJECTURE  
URBAN SPECULATION  
LANDSCAPE FUTURES

BLDGBLOG ("BUILDING BLOG") IS  
WRITTEN BY GEOFF MANAUGH. THE  
OPINIONS EXPRESSED ON



# landscape + urbanism <sup>BLOG</sup>

from landscape architecture to landscape urbanism

MONDAY, AUGUST 2, 2010

## Restoring the Garden of Eden

A great feature from [Spiegel Online](#) covers the work of Azzam Alwash, a US/Iraqi hydraulic engineer aiming to restore what were once vibrant wetlands flourishing in the cradle of civilization through an organization called Nature Iraq. While most news coming from the region focuses on bricks and mortar rebuilding, it's important to note the power of restoration of ecosystems in rebuilding efforts. The connection between people and land is vital.



:: image via [Eden Again](#)

The area was originally marshland fed from the Tigris and Euphrates rivers. From the [article](#): "Only 20 years ago, an amazing aquatic world thrived in the area, which is in the middle of the desert. Larger than the Everglades, it extended across the southern end of Iraq, where the Tigris and Euphrates rivers divide into hundreds of channels before they come together again near Basra and flow into the Persian Gulf."

This is especially evident in satellite photos of the region from 1976 and 2002, showing the widespread ecosystematic destruction of the marsh.



Dialogue and siftings from Portland, Oregon focusing on landscape architecture, sustainable urbanism, vegetated architecture, urban agriculture, living walls, green roofs, ecological planning and landscape urbanism theory.

Jason A. King, *ASLA CLARB LEED* Landscape Architect . Urbanist Principal | [TERRA.fluxus](#)

contact: [email](#)  
twitter: [@landurb](#)  
delicious: [bookmarks](#)

SUBSCRIBE VIA EMAIL

Enter your email address:

Subscribe

Delivered by [FeedBurner](#)

TWITTER

I'm still not convinced. RT @MetropolisMag: Vertical Farming Comes Down To Earth: <http://bit.ly/cqOjXQ> about 18 hours ago

RT @lutzfernandez: Upcoming talks by Carjacked co-authors: Powell's Hawthorne, Portland, 8/5 7:30pm; <http://bit.ly/bZueZ2> about 20 hours ago

Seattle Chews: On New Rules For Street Food | <http://ow.ly/2k1nf> about 20 hours ago

Agreed... RT @phillydesign: disappointed that the Periodic Table of Viz Methods is only a mediocre viz itself. about 20 hours ago

l+u | Restoring the Garden of Eden: A great feature from Spiegel

search over 2,300 plant varieties

MONROVIA



monrovia.com

[advertise here](#)

I Recommend

Recovering L... (Paperback - A... \$16.47



**The Siemens Sustainable Community Awards**  
Honoring cities and towns whose achievements in sustainability are national examples.  
[Apply here now](#)



## BUZZ



### Homes on the Move

Maggie Tickman | November 11th | 90

When the federal government decided to build a hospital on top of a New Orleans neighborhood, several housing nonprofits and citizens lobbied a plan to move threatened homes.

#### RECENT

- [Straight from the Sewer](#) | [Hankla Kluge](#) | November 10th | 90
- [Who's Scared of a Transit Bridge?](#) | [Michael Berkman](#) | November 8th | 94
- [City/Culture: How Fallen Fruit Changes, Challenges Cities](#) | [Jeremy Rocoberg](#) | November 5th | 90

[SUBSCRIBE NOW](#) only \$29 a year

## COLUMNS



### Grassroutes

With the help of Apple Computer, Chicago gets a new transit station. But at what cost do we allow private interests to take over public spaces?

Yonah Freemark | November 10th | 99



## FEATURES

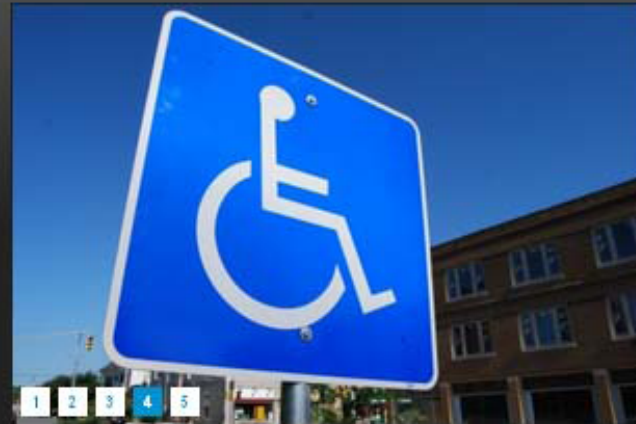

### Open Cities | Web Accessibility 2.0

The rise of Web 2.0 technologies, increasing Internet use, and the growing number of people with disabilities means that web accessibility is more important than ever.

Christina Madera | [Read more](#)

## METRO MATTERS PODCAST

view with Elizabeth Kneebone and 0:00

Latest Wednesday, October, 20th 2010 | [More episodes](#) | [Subscribe in iTunes](#)

## REGIONS

### CENTRAL

- The High Cost of Electric Cars
- The Urban Black Swan
- Deliberating a More Livable Denver
- Building a City at Burning Man
- Social Innovation Takes Root in College Towns

### EAST COAST

- Making Tough Transportation Decisions in Maryland
- Forging our Urban Futures: The Loeb Fellows kick off 40
- The High Cost of Electric Cars
- Interview with Andrew Dabell: 2010 Ed Bacon Student Design Competition
- Meet the Next American Vanguard: Mega-Canking

### MIDWEST

- Straight from the Sewer
- The Mistake by the Lake: A Slicks low by Photographer Chris Mortallini
- The Front Lines of the Big Light Fight: Part II
- The Front Lines of the Big Light Fight
- Working for a Billboard-Free Future in Milwaukee



## TOPICS



### Infrastructure

Who's Scared of a Transit Bridge? by [Michael Berkman](#)



### Governance

Meet the Next American Vanguard: Marvin Chabot by [Jelle Pijpker](#)

## CURRENT ISSUE

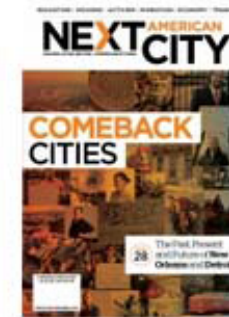

## EVENTS

NOV 17, 2010 - NOV 19, 2010  
[Build Boston 2011](#)  
Boston

DEC 06, 2010 - DEC 10, 2010  
[EcoBuild USA](#)  
Washington DC

APR 03, 2011 - APR 03, 2011  
[BrowlieKit 2011](#)  
Philadelphia

[More events...](#)

## NEWSLETTER

Enter your email

Select your state

[Sign up](#)



Live, Work & Visit  
The first bicycle city



Sustainable, Green,  
and High Performance



**The Siemens Sustainable Community Awards**  
Honoring cities and towns whose achievements in sustainability are national examples.

[> Apply here now](#)

**SIEMENS**

## ABOUT US

Next American City is a 501(c)(3) nonprofit organization, dedicated to promoting socially and environmentally sustainable economic growth in America's cities and examining how and why our built environment, economy, society and culture are changing. We achieve this goal through the publication of our quarterly magazine and interactive website, our emerging leaders program, events across the country, and advocacy on issues central to the future of cities. Through these programs, we observe, document, and conceive realistic solutions about how to improve cities—how to ensure that future generations' lives are improved, and not made more dangerous or unnecessarily complicated by the decisions we make. We do so from the front lines of urban change and innovation.

Next American City deeply appreciates the support of the Annie E. Casey Foundation, Living Cities, Rockefeller Foundation, Surdna Foundation, William Penn Foundation, Dan & Joanna Rose as well as our many other generous donors across the country.

Support our work by making a 100% tax-deductible donation to Next American City today.

Next American City  
1315 Walnut Street, Suite 902  
Philadelphia, PA, 19107  
P. 215.546.4128  
F. 215.261.6009  
[info@americancity.org](mailto:info@americancity.org)

## CURRENT ISSUE

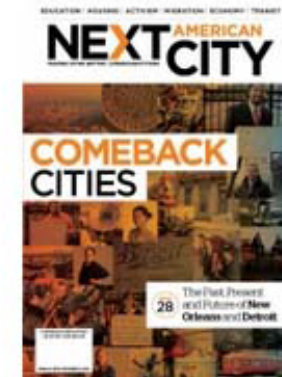

## EVENTS

- NOV 17, 2010 - NOV 19, 2010  
[Build Boston 2011](#)  
Boston
- DEC 06, 2010 - DEC 10, 2010  
[EcoBuild USA](#)  
Washington DC
- APR 03, 2011 - APR 03, 2011  
[Brownfields 2011](#)  
Philadelphia
- [More events...](#)

## NEWSLETTER

Enter your email

Select your state

## Our Team



John Cary, *President & CEO*, joined Next American City in July 2010 to oversee and grow the organization's myriad initiatives and relationships. Previously, he served as the long-time executive director of San Francisco nonprofit Public Architecture. John is the editor of *The Power of Pro Bono: 40 Stories about Design for the Public Good by Architects and Their Clients*, published in 2010 by Metropolis Books / Distributed Art Publishers. He is also a senior fellow of the Design Futures Council, a fellow of the American Academy in Rome, and recently held the Public Affairs Practitioner Residency at the Rockefeller Foundation's Bellagio Center.



Tivoni Devor, *Director of Partnerships*, joined Next American City in December 2009, and oversees the organization's sponsorships and advertising relationships. Tivoni co-founded a touring film festival that criss-crossed the country four times in a converted bio-diesel fueled school bus, is a certified braille transcriber, Americorps® VISTA alum, and is completing his MBA at Drexel University.



Julia Serazio, *Executive Editor*, joined Next American City in January 2009. She updates [americancity.org](http://americancity.org) on a daily basis and edits the quarterly magazine. Prior to joining Next American City, Julia worked for *Condé Nast Portfolio* and *New York Magazine*. She holds a Master's in Journalism from Columbia University.



Diana Lind, *Editor at Large*, served as Editor in Chief from March 2008 to July 2010, and its Publisher from January 2009 to July 2010. Prior to joining Next American City, she authored the book *Brooklyn Modern* and was a freelance editor at *Architectural Record* magazine and Rizzoli International Publications. She is now the program director of the New Cities Foundation and at work on two books concerning global urban affairs.



Anthony Sewski, *Creative Director*, has worked with Next American City since May 2009. Anthony





- >> *cityLAB on CNN International and CNN.com on Future Cities*
- >> *cityLAB exhibits at the 2010 Venice Biennale*
- >> *cityLAB awarded grant to study alternative TODs*
- >> *cityLAB featured in Newsweek and on MSNBC*
- >> *cityLAB awarded high speed rail research grants*

**WPA 2.0**



**California High Speed Rail and Urban Form**



**10K Pacoima: Backyard Homes**



**Flip-A-Strip**





## Stanley Greenberg: City as Organism, Only Some of it Visible

Photographer Stanley Greenberg talks to us about hidden systems, the photographer's role in inspiring transformation, and issues of access, security and the public's right to know. →



All features »

### LIVE EVENTS



#### Touring Roosevelt Island

by Variok Shute

Yesterday was a beautiful day for wandering along Roosevelt Island's waterfront. The Omnibus team and fifty of our friends spent the afternoon learning about the history of the masterpiece, seeing one of the

### ACT LOCAL



#### From Brownfields to Greenfields: A Field Guide to Phytoremediation

by Kaja Kühl

Urban designer Kaja Kühl illustrates how to use plants to clean up contaminated sites, a cost-effective

### MAKE IT VISIBLE



#### The Brooklyn Typology Project

by Neil Freeman

Artist and urban planner Neil Freeman reflects on ways web-based art practice, urban planning data and tireless neighborhood exploration can inform each other, using his own work as a case study. →

### SEARCH

### STAY IN TOUCH

Sign up for our weekly email and follow us on

[twitter](#)
[facebook](#)
[flickr](#)
[rss](#)

### FORUM

#### Cities: Lapham, Krulwich, Dolkart and Inaba

by Caitlin Blanchfield

At the outset of *Cities*, a conversation on the future of urbanism hosted by Columbia's Studio-X, moderator Mark Wigley toasted to forging new friendships in a coming era of dynamic, if uncertain, city design. Considering the cumulative intellectual... →

#### The Omnibus Roundup – Open Cities, Candela Found, Playgrounds, “Cities,” Huxtable and Erasure

by Urban Omnibus

##### #OPENCITIES

As our Twitter followers have no doubt noticed, members of the Omnibus team are currently in Washington, DC for Next American City's conference *Open Cities: New Media's Role in Shaping Urban Policy*. It has been two days of thought-provoking conversation about such topics as "Living Local in a..." →

#### Living Concrete/Carrot City: What do you want from your city's soil?

by Sarah Snider

What do you want from your city's soil? There are many homegrown and local agriculture ideas in *Living Concrete/Carrot City*, an exhibition currently on view at Parsons The New School for Design, and they're worth a look. The projects range from farm visits for families to bodega research, education and... →

#### Forever Trapped Between Jacobs and Moses

by Zhenya Merkulova and Paul Gates

The exhibition of Paul Rudolph's Lower Manhattan Emergency project currently on

## About the Omnibus

---

Urban Omnibus is an online project of the Architectural League to create a new kind of conversation about design and New York City. We commission, gather and deliver the insights of [journalists](#), [architects](#), [planners](#), [designers](#), [artists](#), [activists](#), [scholars](#) and [citizens](#). The Omnibus features multi-media content to showcase design innovation, critical analysis and local expertise across a broad range of topics and locales, creating bridges between various communities of interest. Urban Omnibus makes vivid the processes and possibilities shaping New York. Our goal is to increase understanding of the city we have and encourage ideas that can lead to a more inclusive, more sustainable, more beautiful city that could be. Read more about [Why Urban Omnibus?](#) in a [forum post](#) by Rosalie Genevro, the League's executive director, published when the site first launched.

We post a new feature each Wednesday, with posts to our forum throughout the week. So please check back often. You can also subscribe to our [RSS feed](#), or follow us on [Facebook](#), [Flickr](#), and [Twitter](#). For anything else, you can reach us via email at [info \(at\) urbanomnibus \(dot\) net](mailto:info@urbanomnibus.net).

Unless otherwise specified, all material on this site is licensed under a [Creative Commons Attribution-Noncommercial-No Derivative Works license](#).

---

Stay in touch with the Omnibus! Send us your email and we'll keep you posted about upcoming features and events.

Email

valid email required

**Submit**

## Collaborators

Urban Omnibus is powered by a diverse group of [journalists](#), [architects](#), [planners](#), [designers](#), [artists](#), [activists](#), [scholars](#) and [citizens](#), all of whom contribute their knowledge, opinions, and expertise to this project. [Click here](#) to see a list of the people who have collaborated with us thus far.

## Staff

**Cassim Shepard**  
*Project Director*

**Varick Shute**  
*Project Manager*

**Meredith Baber**  
**Purva Jain**

**William Martin**  
**Eric Peterson**  
*Project Associates*

## Editorial Board

**Rosalie Genevro**  
*Chair, Executive Director,*  
*The Architectural League of New York*

**Kadambari Baxi**  
*Contributing Editor*

**Andrew Blum**  
*Contributing Editor*

**Susan Morris**  
*Consulting Editor*

## Advisory Committee

**Adam Greenfield**  
*Director of Design Director,*  
*Nokia*

**Olympia Kazi**  
*Director,*  
*Institute for Urban Design*

**Hoong Yee Lee Krakauer**  
*Executive Director,*  
*Queens Council on the Arts*

**Laura Kurgan**  
*Director, Spatial Information Design Lab,*  
*Columbia University Graduate School of Architecture, Planning and Preservation*

**Deborah Marton**  
*Executive Director,*  
*Design Trust for Public Space*

**Ellen Pollan**  
*Director, South Bronx Cultural Corridor,*  
*Brooklyn Council on the Arts*

**Daniel Seltzer**  
*Technology Strategist*

**Mark Shepard**  
*Co-director, Center for Architecture and Situated Technologies,*  
*University at Buffalo*

**Beth Stryker**  
*Architect and Media Artist*

**Rosten Woo**  
*Executive Director,*  
*Center for Urban Pedagogy*

## Web Design

[Red Antenna](#)

## Support

The development and pilot phase of Urban Omnibus have been made possible by the the NYC Cultural Innovation Fund of the Rockefeller Foundation. Urban Omnibus is also supported by public funds from the National Endowment for the Arts and the NYC Department of Cultural Affairs, in partnership with the City Council. To find out more about supporting Urban Omnibus, [click here](#).

~~appendix a: building a website~~

~~appendix b: design iterations +~~

~~precedents~~

appendix c: notes + sketches

# Overview

①

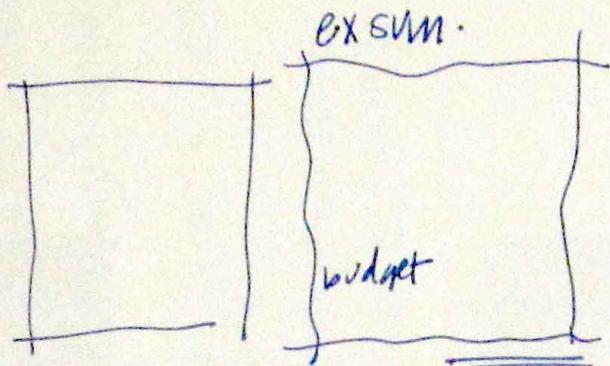

# ④ "project scope possibilities"

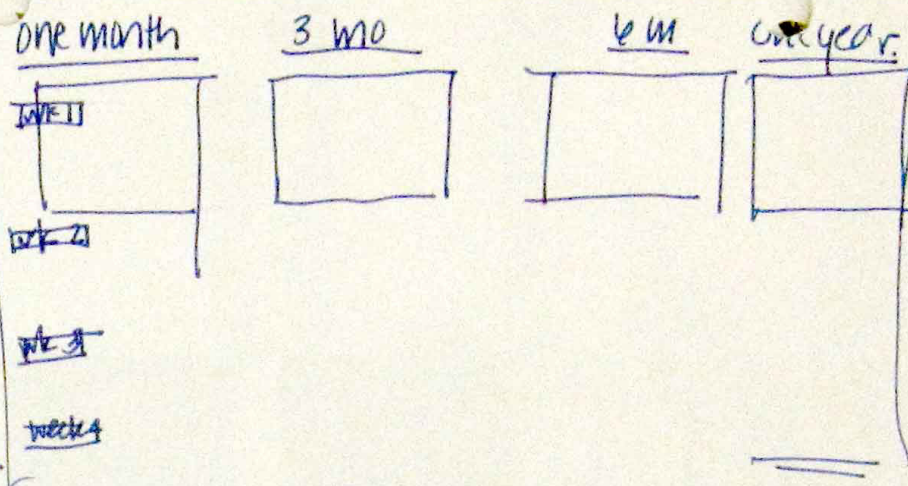

# ② precedents.

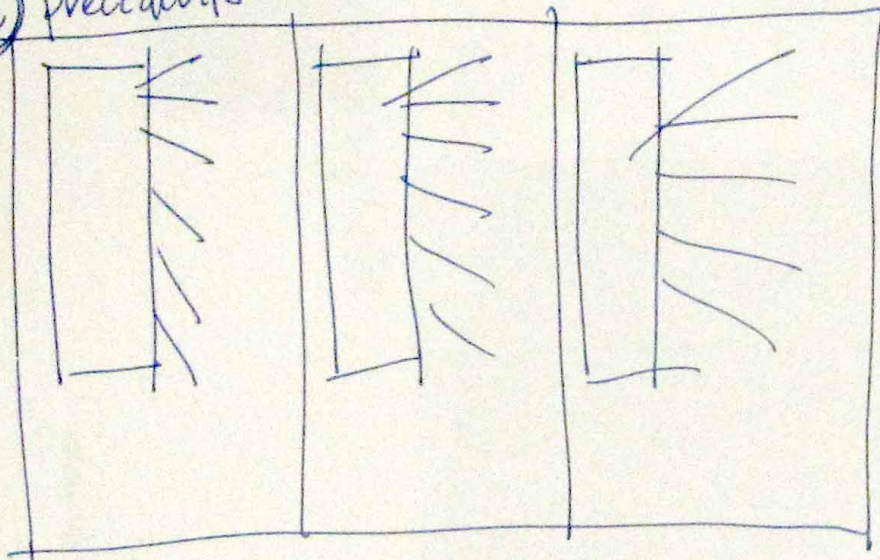

# "layout": the possibilities.

③

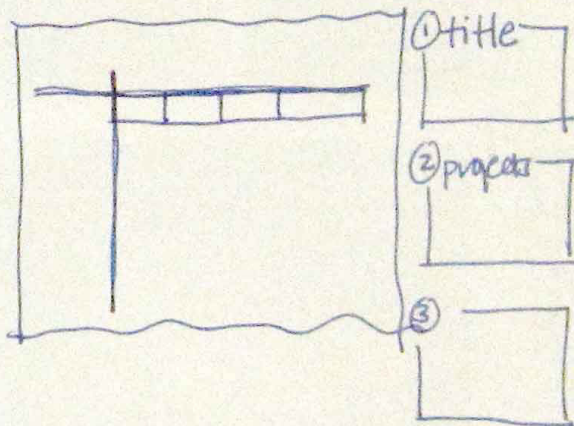

# 4b the future.

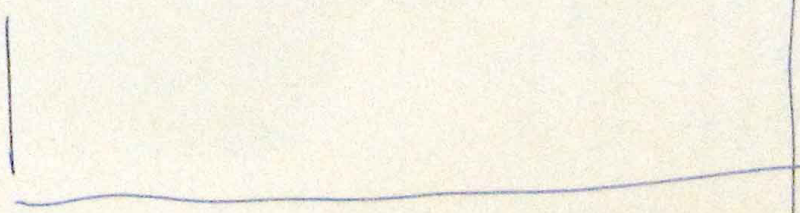

# landscape urbanism

Why can't writing about landscape architecture be the same as our projects – fun, playful, exciting, useful, relevant, innovative, revealing, smart?

a website about landscape, architecture, and urbanism | [www.landscapeurbanism.com](http://www.landscapeurbanism.com)

## why is landscape architecture underwritten?

There is a dearth of writing about landscape, urbanism, and the pressing issues of landscape architecture today. The field has progressed immensely over the last 50 years but occupies a relatively underappreciated realm of public dialogue and perception.

## the vision:

- » Create a simple, evocative website for and about landscape architecture, architecture, and urbanism.
- » Increase connections within and beyond the field of landscape architecture.
- » Tap into digital networks and expand our potential scope of work
- » Emphasize interdisciplinary nature of landscape architecture, architecture, planning, design, preservation, policy, and art.
- » Create an accessible resource for people within and beyond the field.
- » Create a tool for inter-office use and SWA recognition.

## project goals:

**Create a better means of connection with the public.** The average person doesn't know the importance of public space, how space gets designed, or who is involved in the design process. There should be a better context for communicating about the profession beyond the profession.

**Design a relevant reference for landscape architects, planners, and architects.** As designers, we need stellar systems of organization to catalogue projects, places, things in one place. This website can begin to catalogue ideas, information, and exchange.

**Provide a platform for ongoing discussions about landscape urbanism.** Most blogs today are "company blogs" – written solely about the company, for the company, or for internal use. These blogs are a waste of time and energy. Blogs and websites need to be about the consumer and the end-user: about the clients, the process, and the design. The most relevant websites today are useful, timely, and a rich resource for visitors interested in landscape and design.

# the components

What makes a good website?

HOME | PROJECTS | NEWS | BOOKS | PROFILES | ABOUT

## the content:

HOME: Introduction to the site. News Feed. Advertising campaign #1.

PROJECTS: Projects by category. Project submittal templates (such that anyone from any firm can upload 3-4 images, project text, and tag words).

NEWS: Features, posts, and blogs by contributors. Contributions can come from within and beyond the firm. Modeled after "Planetizen" approach.

BOOKS: Recent highlights in books, landscape publications, and interdisciplinary work.

PROFILES: A page featuring firms, people, and schools. Submittal templates for each will be designed and provided.

DETAILS: Particular nuances, developments, and project finishes of interest.

ABOUT: Purpose of the website, authors, editors, and contributors.

## relevant precedents:

Websites under review for content, organization, structure + site layout:

ASLA  
Architecture + Morality  
Anthropology  
Architizer  
AIA-SF  
BLDGBLOG  
Balmori  
Dwell  
A Daily Dose of Architecture  
The Dirt  
Field Operations  
Inhabitat  
Land + Living  
Livable City  
Life Without Buildings  
Landscape+ Urbanism  
Metropolis  
New Geography  
Next American City  
Planetizen  
Planning  
Pruned Landscape Architecture  
Retro Renovation  
SWA Group  
SPUR  
The Where Blog  
Topophilia  
Tree Hugger  
Urban Photo  
Urban Observer  
Worldchanging

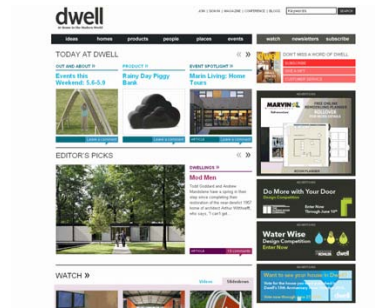

a website about landscape, architecture, and urbanism | [www.landscapeurbanism.com](http://www.landscapeurbanism.com)

2010 SWA Fellowship Proposal: SARAH KATHLEEN PECK  
project: LANDSCAPE URBANISM WEBSITE

# the possibilities

What can this become?

HOME | PROJECTS | NEWS | BOOKS | PROFILES | ABOUT

## the small goal: an advertising campaign.

Create a slideshow of images in a series of campaigns to rotate through the website. Start "this is landscape urbanism" campaign and "this needs landscape urbanism" campaign (see right).

## the medium goal: design four subpages.

Create the first four subpages: Home, About, Projects, Blog. Create a standard submittal template to build online content.

## the large goal: a kick-ass website.

## the gigantic goal: spinoffs.

Create a site that launches Landscape Urbanism into the realm of ready-for-print publications (a magazine? a newsletter? a series of books?). The possibilities are endless.



a website about landscape, architecture, and urbanism | [www.landscapeurbanism.com](http://www.landscapeurbanism.com)

2010 SWA Fellowship Proposal: SARAH KATHLEEN PECK  
project: LANDSCAPE URBANISM WEBSITE

# the details

20 workdays,  
4 months,  
\$10,000

HOME | PROJECTS | NEWS | BOOKS | PROFILES | ABOUT

## phasing:

**phase 1: precedent research**      timeframe: 1 day      cost: \$0.00  
Analyze existing websites related to landscape urbanism. Create resource database for landscape urbanism (for "About" section of website).

**phase 2: template design**      timeframe: 1 day      cost: \$0.00  
Create three iterations of landscape urbanism website; review with design team (1 principal, 1 Associate, 1 Image Dept Rep, tbd). Begin "This is Landscape Urbanism" 10-image campaign. Begin "This Needs Landscape Urbanism" 10-image campaign.

**phase 3: web coding + back end**      timeframe: 10 days      cost: \$8,000.00  
Install and upload wordpress; code existing site. Consultants: Blink Tag, Inc - a web design firm that specialize in websites for planning and urbanism ([www.blinktag.com](http://www.blinktag.com)). Fee: \$8000.00 for consultant services.

**phase 4: content**      timeframe: 3 days      cost: \$2,000.00  
Upload content to projects: 10 categories, 2 projects each category. Design home page & landscape ad campaign online. Set up blog template and news feed. Create submittal template. Delegate 10 entry submissions.  
Incidentals: hosting, server, template and website registration, image rights. \$2000.00

**phase 5: network**      timeframe: 2 days      cost: \$0.00  
Design "submit your project" page. Create email campaign for submissions.  
Design "submit your firm" page. Create email campaign for submissions.  
Design "submit a profile" page. Create email campaign for submissions.

**phase 6: inter-office collaboration**      timeframe: 3 days      cost: \$0.00  
Possible strategy: create a team of 6 people (1 per office) committed to 1-2 posts per month for one year, to generate content and attract outside contributors.

**phase 7: launch.**

S	M	T	W	T	F	S
				1	2	3
4	5	6	7	8	9	10
11	12	13	14	15	16	17
18	19	20	21	22	23	24
25	26	27	28	29	30	31

S	M	T	W	T	F	S
1	2	3	4	5	6	7
8	9	10	11	12	13	14
15	16	17	18	19	20	21
22	23	24	25	26	27	28
29	30	31				

S	M	T	W	T	F	S	
				1	2	3	4
5	6	7	8	9	10	11	
12	13	14	15	16	17	18	
19	20	21	22	23	24	25	
26	27	28	29	30			

S	M	T	W	T	F	S	
						1	2
3	4	5	6	7	8	9	
10	11	12	13	14	15	16	
17	18	19	20	21	22	23	
24	25	26	27	28	29	30	
31							

S	M	T	W	T	F	S
	1	2	3	4	5	6
7	8	9	10	11	12	13
14	15	16	17	18	19	20
21	22	23	24	25	26	27
28	29	30				

S	M	T	W	T	F	S	
				1	2	3	4
5	6	7	8	9	10	11	
12	13	14	15	16	17	18	
19	20	21	22	23	24	25	
26	27	28	29	30	31		

## credentials:

SARAH KATHLEEN PECK  
[www.sarahkathleenpeck.com](http://www.sarahkathleenpeck.com)

**Publications:** VIA: Occupation, April 2008. Money, Inflation, and Economics for Planners: APA, Oct 2009. Making the School-to-Job Transition, APA, Jan 2009. Last Child in the Woods: Review, APA, Jan 2008.  
**Web Design:** Front-end graphic design: [www.sarahkathleenpeck.com](http://www.sarahkathleenpeck.com)

BLINK TAG INC: WEBSITE DEVELOPMENT  
[www.blinktag.com](http://www.blinktag.com)

a website about landscape, architecture, and urbanism | [www.landscapeurbanism.com](http://www.landscapeurbanism.com)

2010 SWA Fellowship Proposal: SARAH KATHLEEN PECK  
project: LANDSCAPE URBANISM WEBSITE

## general thoughts + personal thesis:

*my interest in is systems organization and design: I am interested in the spatial layout and design of information and urban settings, in virtual as well as physical space. I am drawn to both urban design (physical/spatial design) of the world at a human-scale and a city scale. I am also interested in the more intangible qualities of information structures, navigation clues, wayfinding, and the organization of information in space - graphically and perceptually.*

*For example, how each user navigates through particular computer processes - whether reading and unfolding the layers of a website - creates a user-specific storyline that, in its most complex, must be extensively revisited (through periodic troubling shooting) for continuity... designers who navigate CAD both succumb to the program's flaws, and, more organically and creatively, adapt particular uses/skill sets to develop multiple ways accomplish similar end-tasks. In that vein, websites are continually evolving, dynamic, interactive entities that become obsolete after the information sets change over time. There are many parallels between the design of information space and the design of physical space.*

*I want to design a website / platform / library for landscape architects to share, interact, and post. The writing will be lively and interactive; the project pages will be innovative and unique; the discussions .. (should we have "discussion threads"?) should provide more content to the website than the sole influence of one designer. I hope to provide the platform for an ongoing, evolving discussion.*

## project [general] thesis:

**what:** Create a website for + about landscape, architecture, and urbanism.

**why:** Because landscape architecture and urban matters are largely underwritten. Particularly in the public realm.

More specifically, create a website that provides a space for an interactive dialogue about **landscape urbanism** and what it means to design landscapes and urban spaces today. To create a space that shares what landscape urbanism is with a larger public audience.

### the vision:

- Create a simple, evocative website for and about landscape architecture, architecture, and urbanism.
- Increase connections within and beyond the field of landscape architecture.
- Tap into digital networks and expand our potential scope of work
- Emphasize interdisciplinary nature of landscape architecture, architecture, planning, design, preservation, policy, and art.
- Create an accessible resource for people within and beyond the field.
- Create a tool for inter-office use and SWA recognition.

### project goals:

- **Create a better means of connection with the public.** The average person doesn't know the importance of public space, how space gets designed, or who is involved in the design process. There should be a better context for communicating about the profession beyond the profession.
- **Design a relevant reference for landscape architects, planners, and architects.** As designers, we need stellar systems of organization to catalogue projects, places, things in one place. This website can begin to catalogue ideas, information, and exchange.
- **Provide a platform for ongoing discussions about landscape urbanism.** Most blogs today are "company blogs" – written solely about the company, for the company, or for internal use. These blogs are a waste of time and energy. Blogs and websites need to be about the consumer and the end-user: about the clients, the process, and the design. The most relevant websites today are useful and timely
- Design a site that captures three separate components: physical design; web design; good, articulate writing about design – into a relevant, useful resource.

### personal goals for the fellowship:

- **New programs/skills:** dreamweaver, html, css, flash. recording digital presentations.
- **Showcase presentation skills.** Create a series of useable pdf-presentations.
- **Focus on writing.** Write, write, write.
- **Think critically about landscape architecture, urbanism,** and my role in the field as a new designer. What can new designers bring to landscape architecture? How can we begin to think critically about how we design, what we design, and what tools we use for marketing, designing, engaging, etc?
- **Create a manifesto for the website:** why is it necessary?
- **Dream big:** imagine projects on landscape-urbanism post-website.

## about sarah:

**PECK, SARAH** holds a BA in Psychology & Biology from Denison University and an MLA from Penn Design. Sarah's research at Denison focused on the relationships between design, environment, and behavior. This background helped shape her understanding of landscape architecture as a ground plane for the complex choreography of movements and behaviors that occur within a place. At Penn, Sarah's graduate work focused on large scale regional and urban planning, environmental design, and writing. A winner of the Peter Latz student competition, she participated in the international week-long conference in Freising, Germany, to redevelop the oldest brewery and monastery in Europe.

Sarah is interested in the tools with which designers communicate their ideas - graphically, publicly, and in written works - and the influence that landscape architects can have on both our immediate and future environments. Prior to joining SWA, Sarah was the Assistant Editor for *via//occupation*, the Penn Design journal for architecture, landscape architecture, and design. While at SWA, she has worked on the San Jose Environmental Innovation Center, Longmu Bay, University of the Pacific Three City Master Plan, the Master Plan for Borivali, the Stockton Gateway Master Plan, the Ningbo Central Park competition, and the Shanghai Financial Center. In her free time she enjoys writing, reading, gardening, biking to work, and training for triathlons.

## project experience:

### **B.A. Thesis:**

Sarah did her thesis in Environmental Psychology and Behavioral Psychology, studying the relationships between design, environment and behavior. This background helped her create a lens by which to view landscape architecture and planning as the ground plane for the complex choreography of movements and behaviors that occur within a place.

### **Graduate work:**

While at Penn, Sarah's graduate work focused on large scale regional and urban planning, environmental design, and writing. A selected nominee for the 2007 Peter Latz student competition, she participated in the international week-long design study in Freising, Germany, to help develop conceptual plans for the redevelopment of the oldest brewery/monastery in Europe.

### **Professional Projects:**

[Shanghai Tower - Financial Center](#). Shanghai, China. Schematic Design, Planting Design, Design Development. SWA Group, 2008-2010.

[Longmu Bay Master Plan & Resort Development](#). Hainan, China. Master Plan, Schematic Design, Planting Design, and Design Development. SWA Group, 2009-2010.

[San Jose Environmental Innovation Center](#). San Jose, CA. DD and CD packages, LEED-Silver project status. SWA Group, 2010

[University of the Pacific Campus Master Plan](#). Stockton, San Francisco and Sacramento, CA. Three City Campus Master Plan. SWA Group, 2010.

[Stanly Ranch Napa Valley](#). Napa, CA. Design Guidelines, Environmental Impact Report, and Planning. SWA Group, 2009.

### **Competitions:**

[Ningbo Central Park](#). Conceptual designs, models, boards, and presentation. Winning proposal, SWA Group, 2009.

[NASA Ames](#). Residential and mixed-use land redevelopment. Master Plan and Financial Proposal. Runner up, SWA Group, 2009.

# unfiltered research, continuous thoughts

## introduction

Landscape urbanism is receiving renewed attention and importance, in that it represents an idea that distinct divisions in landscape architecture, architecture, planning and urban design does not accurately reflect the reality of project design and space creation.

Landscape urbanists are involved in placemaking, systems analysis, process considerations, economic development, community development, regionalism, sustainability and city development.

the practice of landscape architecture is not a new phenomenon.

Landscape urbanism reflects the increasingly interdisciplinary nature of design work and collaborative project teams. This interdisciplinary nature is further reflecting/revealing the changing agenda of place-making, and what it means to design.

## A brief history of the idea of landscape urbanism

The term **landscape urbanism** generated prominent discussed in design discourse in the 1990's (?) as an attempt to move beyond the rigid disciplines of landscape architecture and urban design, suggesting that the overlapping disciplines/practice of landscape architecture, architecture, urban design, and planning is a more accurate means of engaging in design of the physical environment.

For a short while, the embattled (?) discourse to define what landscape urbanism "is" reflects the struggle to move beyond "traditional definitions of well-defended disciplinary boundaries." (Charles Waldheim) – ironically, trying to define a discipline that in its nature, suggests that the scope of work and design parameters are to be left somewhat loose and subject to interpretation/adaptation.. and adopt the lenses of designers, place ... James Corner suggests that Landscape Urbanism is a successful in that it is providing "a framework for new forms of experimentation, research, and process' (p 25 topos).

## The intersection of "landscape" and "urbanism"

What are these two words, "landscape," and "urbanism,"? At its heart, "**urbanism**" looks at the man-made construct of the city (as a place of human density, human features) and all things related to the development and persistence of cities. More loosely, matters of urbanism include spatial geography, economics, politics, social matters and the human or community-oriented nature of people within a place. *(To an extent, then, are all landscapes somewhat 'urban,' then, if they involved people and a tie to or relation to a city?)*

The term "**landscape**" includes "the visible features of land;" the physical, water, living, and human elements of space and terrain. Landscape is often thought to include the built components of human occupation: the cities, houses, and places constructed by people within the space of their living/being/working.

Etymologically, the word “landscape” is thought to be derived from a dutch term referring to “systems of human made spaces in the land” ([http://en.wikipedia.org/wiki/Landscape#cite\\_note-0](http://en.wikipedia.org/wiki/Landscape#cite_note-0)). The idea of landscape is also historically associated with the idea of “scenery,” from the Dutch paintings of landscape scenery in the 16<sup>th</sup> century.

In environmental psychology, landscape is “regarded as the raw material with which to study human perceptions and human information processing,” suggesting that (Daniels and Cosgrove) “any landscape is composed of not only what lies before our eyes, but lies within our heads.”

## What is landscape urbanism?

In this essay, we suggest simply that the spirit of landscape urbanism is . . . the intersection of the man-made matters of the city with the environmental systems and physical/spatial components of landscape architecture and design. In practice, **landscape urbanism** seeks to . . . create landscapes and urban designs that embrace these **environmental** and **human** elements of spatial design.

## What makes landscape urbanism important?

The individual ideas of “**landscape**” and “**urbanism**” both overlap in their critical **human component**. Landscapes and urban matters are related in that they study systems at the human-scale and in relation to human development. But to look merely at people within space neglects the larger scale processes and systems underlying and overlapping urban landscapes. The idea of landscape suggests larger natural systems and processes that take varied amounts of time, and change the earth through biological . . . interactions. Urbanism looks at the complexity of human dwellings in large densities.

## Landscape urbanism and today’s cities?

### When did cities become unsustainable?

### Landscape urbanism: cities

### The persistence of cities

One lens for understanding landscape urbanism is by studying trends of people and the renewed importance of cities (increasing population) – and growth in number of city dwellers / metropolitan areas across the globe. Why are cities growing? How are cities changing?

At its core, landscape urbanism embraces the human and environmental threads/layers/process inherent in city creation/development, place making, and urban redevelopment. Cities are a man-made construction but cannot operate without fully realized and integrated/overlapping/interacting natural systems.

The recent renewed focus on “sustainability” and “LEED” is a response to city, human, and economic systems of the 20<sup>th</sup> century that pushed individual components into such isolation that they eroded quickly in function – as opposed to respecting the delicate complexity of multi-system interactions. Sprawl, as a clear example, is a representation of the complete separation between work and home. This separation reflected the idea that downtowns are for working and suburbs are for living; this ideal quickly deteriorated through spiraling housing costs, negative environmental impacts, and non-sustainable social, economic, and environmental repercussions.

We could argue that cities are experiencing a renewed importance because of the recent emphasis on the overlapping **human** and **environmental** elements that tie cities together as places.



“Simply arriving at your destination is not the point.

Arriving is only a convenient alibi, a reason given as a pretext for what it’s really all about.

What it’s really all about is being on off-road, the path less taken. Finding your own way, and finding the occasional dead end.

Once you you’ve arrived, the fun is over. And you’re left with nothing but the pleasure of looking forward to the next ride.”

2010 landscape urbanism project