

Ritz Carlton Napa Valley

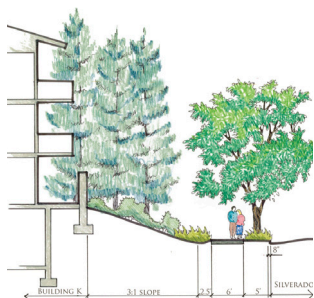
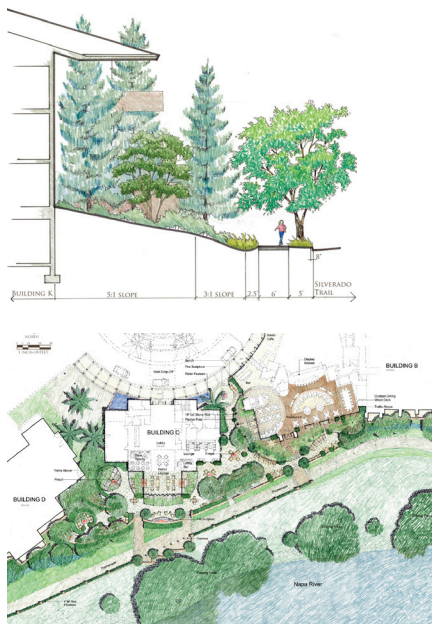

Location
Napa, California

Client
The Continental Companies, LLC
River House Land Company LP

SWA Scope
Landscape Architecture

Size
11 acres (4.5 hectares)

Architect
Nichols Brosch Wurst Wolfe & Associates, Architects

Located along the banks of the Napa River in downtown Napa, this LEED-certified resort includes 351 rooms (both hotel and condominium), a restaurant, a banquet/conference facility, retail space and health spa. SWA's design integrates the project into its northern California wine country site through use of native and Mediterranean plantings, rich local materials for paving and walls, and a variety of inviting gathering areas and plazas to welcome guests and the public alike.

Sustainable design standards include the use of bioswales, low-flow irrigation hardware, and drought-tolerant planting. Site layout encourages pedestrian activity with minimal vehicular access. A riparian zone along the riverfront trail integrates access for public circulation with functional requirements of a new floodwall along the property's western edge.

